

File Location: G:\GIS_Projects\Folder00_Hydro\111440064_BP\III_EPP\IA\MA\PIES_N3\BP\IA\cEnvPP_N3ConstructionSection_Mitigation\ESSMapIndex_479K_BT_BTB_20131217.mxd



Coordinate System: UTM Zone 14N NAD83
 Data Source: MB Hydro, Stantec, ProvMB, NRCAN
 Date Created: November 29, 2013

0 12.5 25 Kilometres

0 5 10 Miles

1:475,000



Legend

- Final Preferred Route
- Section N3
- Map Index Grid (1:10,000)
- Transmission Line
- Mineral Rights
- First Nation
- Provincial Forest
- Provincial Park
- Wildlife Management Area

Bipole III Transmission Line Project
Construction Environmental Protection Plan
 Construction Section N3
 Key Map Index

This page is intentionally left blank.

DOCUMENT PATH: G:\GIS_PROJECT_FOLDER\11440054_BPIII_EPP\ARCMAP\LESS_N3\BPIII_CENVPP_NIN2N3N4C1SECTION\BASEMAP_MAPBOOK_BTBT_STANTEC_20131128A.MXD

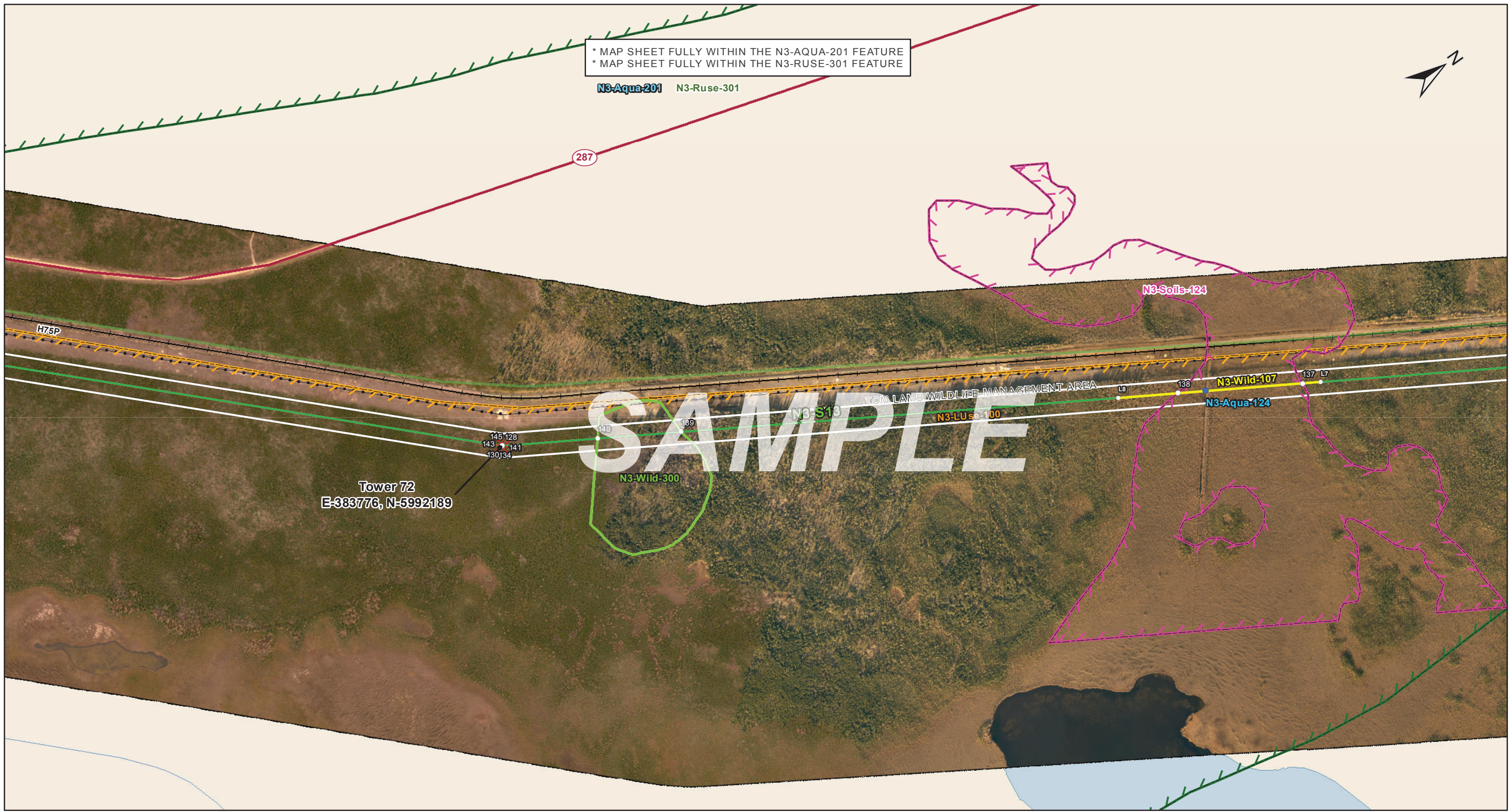

N3-Aqua-201 N3-Ruse-301

Tower 72
 E-383776, N-5992189

SAMPLE



Coordinate System: UTM Zone 14N NAD83
 Data Source: MB Hydro, ProvMB, NRCAN
 Date Created: November 29, 2013

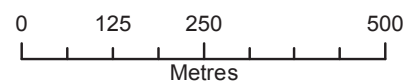

1:10,000

- Land Base**
- Transmission Line
 - Highway
 - Major Road
 - Local Road
 - Winter Road
 - Railway (Operational)
 - Railway (Discontinued)
 - Mining
 - Provincial Park

- Project Infrastructure**
- ★ Angle Tower Locations
 - BPIII Final Preferred Route
 - 66 m Right of Way

- Points of Access***
- Proposed Access Point
 - Major Stream Crossing
 - ▲ Abandoned Rail Crossing
 - ▲ Rail Crossing
 - Transmission Line Crossing
 - Proposed Access Route
- *Labels correspond to BPIII Access Management Database

- ESS Features**
- Water**
 - Water Crossing
 - Wildlife**
 - Birds and Habitat
 - Wildlife, Reptiles/Amphibians
 - Land Use**
 - Conservation
 - Resource Use**
 - Forestry

- Soils and Terrain**
- Permafrost
 - Water**
 - Groundwater

**Bipole III Transmission Project
 Construction Environmental Protection Plan
 Construction Section N3
 Environmentally Sensitive Site Locations**

SAMPLE MITIGATION TABLE (see adjacent KEY for additional information)

MAP NUMBER : 146¹

ESS Group : Permafrost²

Sec-Seg ID	ESS ID	ESS Name	Location	Start	Stop	UTM Zone	Distance
N3-S13	N3-Soils-124	Permafrost	Site: 137 to 138	E-384894 N-5994010	E-384719 N-5993726	14N	333m

Potential Effects: ⁴

Melting or loss of permafrost due to disturbance of the active layer

Specific Mitigation: ⁵

- Carry out construction activities on frozen ground to minimize surface damage and rutting
- Use existing trails, roads or cut lines whenever possible as access route

ESS Group : Birds and Habitat²

Sec-Seg ID	ESS ID	ESS Name	Location	Start	Stop	UTM Zone	Distance
N3-S13	N3-Wild-107	Waterfowl sensitivity area	Site: L7 to L8	E-384697 N-5993592	E-384919 N-5994051	14N	539m

Potential Effects: ⁴

Higher risk of wire collision, risk of wire collision is localized to the right-of-way

Specific Mitigation: ⁵

- Adhere to reduced risk timing windows for protection of birds (August 1- April 30)
- Maintain applicable setback during nesting and breeding timing window

ESS Group : Water Crossing²

Sec-Seg ID	ESS ID	ESS Name	Easting	Northing	UTM Zone	Channel Width	Wet Width	Fish Habitat Class	Habitat Sensitivity
N3-S13	N3-Aqua-124	Unnamed Tributary of Unnamed Lake	384758	5993791	14N	N/A	N/A	No Fish Habitat	Low

Potential Effects: ⁴

Habitat loss & contamination from structure foundations & installations; increased erosion & sedimentation of streams; damage to stream banks; loss of riparian vegetation

Specific Mitigation: ⁵

- Carry out construction activities on frozen ground to minimize surface damage, rutting and erosion
- Use existing trails, roads or cut lines whenever possible as access routes

***Mitigation shown includes only a sample of actual mitigation for the ESS features listed; refer to the Construction Environmental Protection plan for all specific mitigation measures recommended**

KEY to SAMPLe MITIGATION TABLE

1 Map on which ESS listed in the ESS Location Summary tables are illustrated

2 ESS Group classification of ESS shown on the map

3 ESS location summary; includes the following fields:

- Sec-Seg - ID of the construction section (i.e. C2) and segment (i.e. S03) for ESS location
- ESS ID - Site specific ID assigned to each ESS according to **naming convention** listed below
- ESS Name - Brief name/description of ESS
- Easting/Northing - UTM coordinates of ESS location (for points only)
- Location - site identification numbers for the start and stop site points of ESS intersection with the ROW (lines and polygons only)
- Start/Stop - UTM coordinates of the start/stop identification numbers listed in the "Location" field (lines and polygons only)
- Characteristics of stream crossings identified in the ESS Location Summary tables (where applicable and as information is available)

4 Potential effects identified for ESS listed in the ESS Location Summary table

5 Mitigation measures identified for ESS listed in the ESS Location Summary table

ESS NAMING CONVENTION

CATEGORY	GROUP (Number Series Representing Group)	ESS ID (Section ID-Category-Group Number)
Access	Intersection (100)	N3-Acss-100
Ecosystem	Habitat (100)	N3-Eco-100
	Research (200)	N3-Eco-200
	Species of Concern (300)	N3-Eco-300
Heritage	Archaeological (100)	N3-Hert-100
	Cultural (200)	N3-Hert-200
	Historic (300)	N3-Hert-300
Land Use	Conservation (100)	N3-LUse-100
	Crown Land Encumbrance (200)	N3-LUse-200
	Recreation (300)	N3-LUse-300
	Residential (400)	N3-LUse-400
Resource Use	Agriculture (100)	N3-RUse-100
	Food/Medicinal (200)	N3-RUse-200
	Forestry (300)	N3-RUse-300
	Hunting/Fishing (400)	N3-RUse-400
	Trapping (500)	N3-RUse-500
Soils and Terrain	Permafrost (100-200)	N3-Soils-100
	Erosion (300)	N3-Soils-300
	Terrain (400)	N3-Soils-400
Water	Water Crossing (100)	N3-Aqua-100
	Groundwater (200)	N3-Aqua-200
	Wetlands (300)	N3-Aqua-300
Wildlife	Birds and Habitat (100)	N3-Wild-100
	Mammal and Habitat (200)	N3-Wild-200
	Reptiles/Amphibians and Habitat (300)	N3-Wild-300