

**Sinclair Unit No. 17**

**Waterflood Progress Report 2017**

**January 1<sup>st</sup> through December 31<sup>st</sup> 2017**

**Prepared for:**

**Manitoba Industry, Economic Development and Mines**

**Petroleum Branch**

**Prepared by:**

**Tundra Oil and Gas**

**August 2, 2018**

## INTRODUCTION

Sinclair Unit No. 17 Enhanced Oil Recovery (EOR) Waterflood Project was approved on March 1, 2016 with Tundra Oil and Gas (Tundra) as Operator. The EOR Unit area, outlined in blue, contains 4 abandoned wells, 3 producing vertical wells and 14 producing horizontal wells in 48 LSDs in Township 8 Range 28 W1 as shown in the figure below.

**This unit is currently not on injection.**

**Figure 1: Sinclair Unit No. 17 Area Outline**

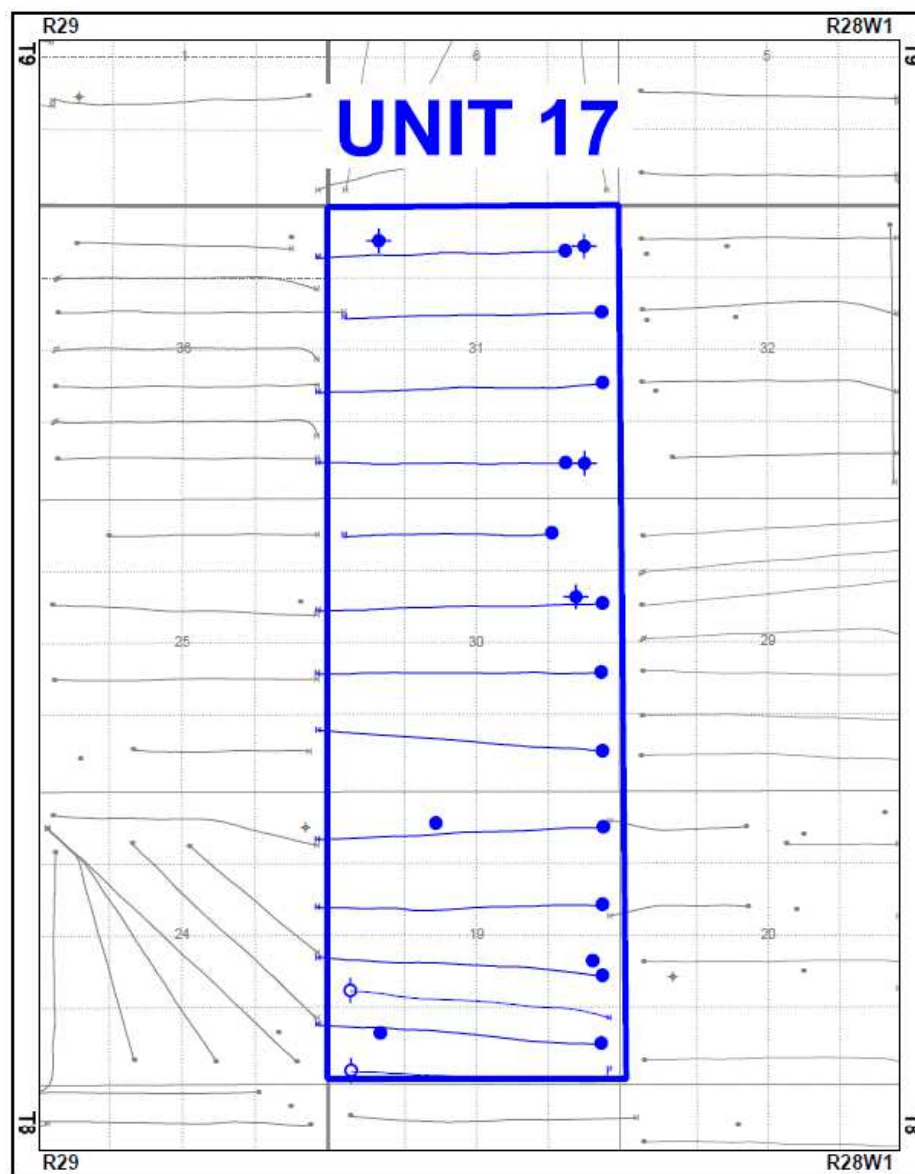

## Sinclair Unit No. 17

Tundra Oil and Gas (Tundra), as the operator of the Sinclair Unit No. 17 Enhanced Oil Recovery (EOR) project hereby submits the 2017 EOR report as per section 73 of the Drilling and Production Regulations.

### a) Monthly oil and water production rates, injection rate, GOR and WOR

MONTH	Cal Dly Oil m <sup>3</sup> /day	Cal Dly Wtr m <sup>3</sup> /day	Cal Inj Wtr m <sup>3</sup> /day	WOR m <sup>3</sup> /m <sup>3</sup>	GOR m <sup>3</sup> /m <sup>3</sup>
Jan-2017	19.50	60.14	0.00	3.08	0
Feb-2017	18.23	58.54	0.00	3.21	0
Mar-2017	17.24	57.12	0.00	3.31	0
Apr-2017	16.71	59.71	0.00	3.57	0
May-2017	14.98	55.24	0.00	3.69	0
Jun-2017	13.85	58.15	0.00	4.20	0
Jul-2017	14.29	54.18	0.00	3.79	0
Aug-2017	15.49	87.80	0.00	5.67	0
Sep-2017	15.11	53.67	0.00	3.55	0
Oct-2017	14.31	49.91	0.00	3.49	0
Nov-2017	13.51	45.11	0.00	3.34	0
Dec-2017	13.24	77.16	0.00	5.83	0

### b) Cumulative volume of oil, gas and water produced and fluid injected

2017 PRODUCTION	
Produced Oil (m <sup>3</sup> )	5,667
Produced Gas (m <sup>3</sup> )	0
Produced Water (m <sup>3</sup> )	21,826
Fluid Injected (m <sup>3</sup> )	0
CUMULATIVE PRODUCTION	
Produced Oil (m <sup>3</sup> )	151,608
Produced Water (m <sup>3</sup> )	267,549

## Sinclair Unit No. 17

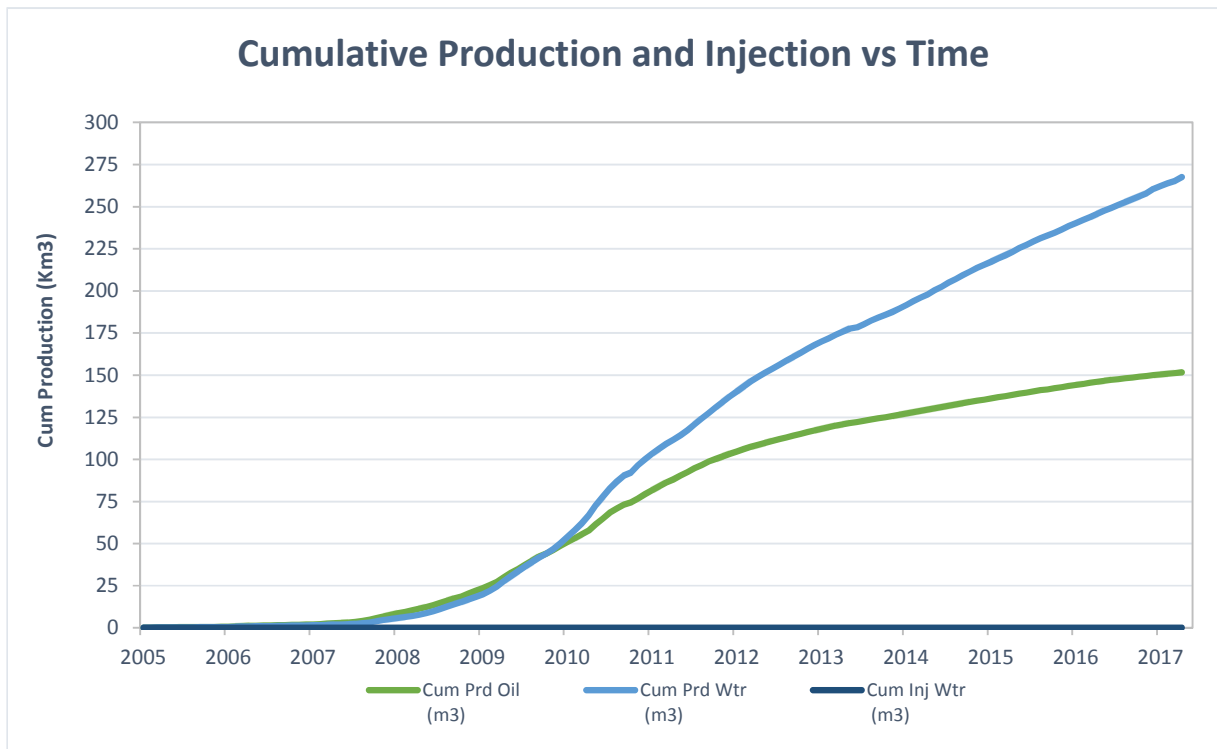

<i><b>UWI</b></i>	<i><b>Type</b></i>	<i><b>Status</b></i>	<i><b>Future Plans</b></i>
100/01-19-008-28W1/0	Horizontal	Producing	-
100/04-19-008-28W1/0	Vertical	Producing	-
102/04-19-008-28W1/0	Horizontal	Drilled & Cased	-
100/05-19-008-28W1/0	Horizontal	Drilled & Cased	-
100/08-19-008-28W1/2	Vertical	Producing	-
102/08-19-008-28W1/0	Horizontal	Producing	-
100/09-19-008-28W1/0	Horizontal	Producing	-
100/14-19-008-28W1/0	Vertical	Producing	-
100/16-19-008-28W1/0	Horizontal	Producing	-
100/01-30-008-28W1/0	Horizontal	Producing	-
100/08-30-008-28W1/0	Horizontal	Producing	-
100/09-30-008-28W1/0	Vertical	Abandoned Zone	-
102/09-30-008-28W1/0	Horizontal	Producing	-
100/16-30-008-28W1/0	Horizontal	Producing	-
100/01-31-008-28W1/0	Vertical	Abandoned Zone	-
102/01-31-008-28W1/0	Horizontal	Producing	-
100/08-31-008-28W1/0	Horizontal	Producing	-
100/09-31-008-28W1/0	Horizontal	Producing	-
100/13-31-008-28W1/0	Vertical	Abandoned Zone	-
100/16-31-008-28W1/0	Vertical	Abandoned Zone	-
102/16-31-008-28W1/0	Horizontal	Producing	-