

Twp 03

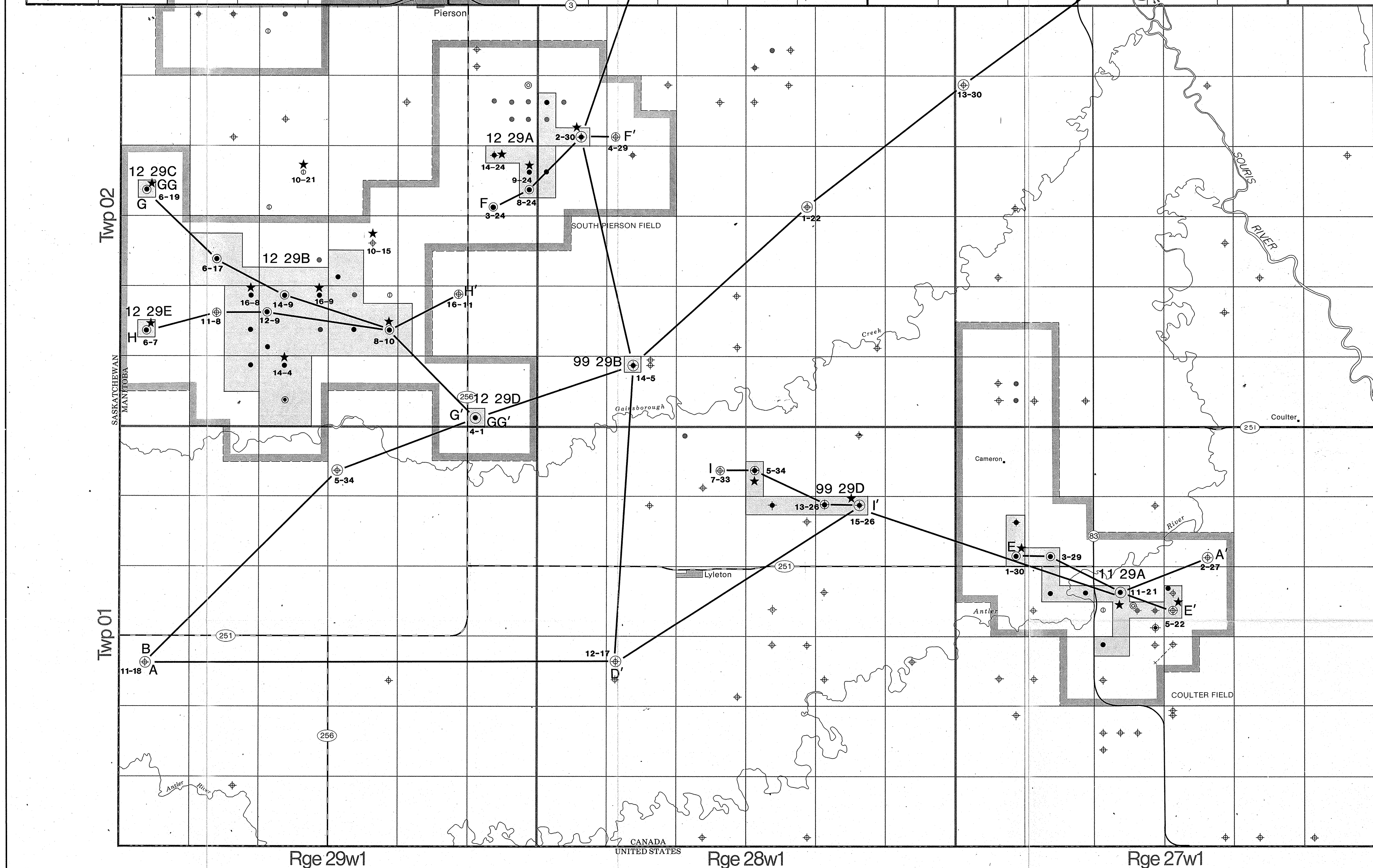

## WELL STATUS INFORMATION

- Standing
- Producer
- ◆ Abandoned producer
- ⊕ Dry and abandoned
- ⊙ Salt water disposal
- ⊙ Salt water disposal (former producer)
- ⊕ Abandoned salt water disposal
- Dual completion
- ×--- Surface location - directional well
- Oil wells are producing from Mississippian-Mission Canyon Formation

## TOPOGRAPHICAL INFORMATION

## CULTURAL FEATURES

- ③ Provincial trunk highway
- ②⑤② Provincial regional road
- Railway
- Built up area, other localities

## BOUNDARY FEATURES

- International
- Provincial
- Township/range
- Section line (surveyed, unsurveyed)
- Oil field
- Lower Amaranth Pools

## FIELD/POOL CODES

PIERSON : Lower Amaranth A Pool 07 29A  
 COULTER : Lower Amaranth A Pool 11 29A

## SOUTH PIERSON :

Lower Amaranth A Pool 12 29A  
 Lower Amaranth B Pool 12 29B  
 Lower Amaranth C Pool 12 29C  
 Lower Amaranth D Pool 12 29D  
 Lower Amaranth E Pool 12 29E

## OTHER AREAS :

Lower Amaranth B Pool 99 29B  
 Lower Amaranth D Pool 99 29D

○—○ Lines of cross-section

★ Indicates wells where cores were examined  
 14-4

Figure: 3  
 POOL LOCATION MAP  
 LOWER AMARANTH PRODUCTION  
 IN  
 COULTER-PIERSON AREA

Scale 1:50 000

KILOMETRES 1 0 1 2 3 4 KILOMETRES

N.T.S. References 62 F/2, 3, 6 &amp; 7

Not to be reproduced in any manner whatsoever without the written permission of the Director of Petroleum

GEOLOGY: M. HUSAIN  
 CARTOGRAPHY: M. McFARLANE, N. BARTON  
 DATE: July, 1989

Manitoba  
 Energy and Mines  
 Petroleum