

Daly Unit No. 7

Waterflood Progress Report 2017

January 1st through December 31st 2017

Prepared for:

Manitoba Industry, Economic Development and Mines

Petroleum Branch

Prepared by:

Tundra Oil and Gas

August 1, 2018

INTRODUCTION

Daly Unit No. 7 Enhanced Oil Recovery (EOR) Waterflood Project was approved under Waterflood Order No. 38, effective January 1st, 2014 with Tundra Oil and Gas as Operator. The EOR project area, outlined in blue in Figure 1, contains 8 vertical and 1 horizontal producing well in 8 LSDs in Section 22, Township 9, Range 29W1.

This unit is currently not on injection.

Figure 1: Daly Unit No. 7 Area Outline

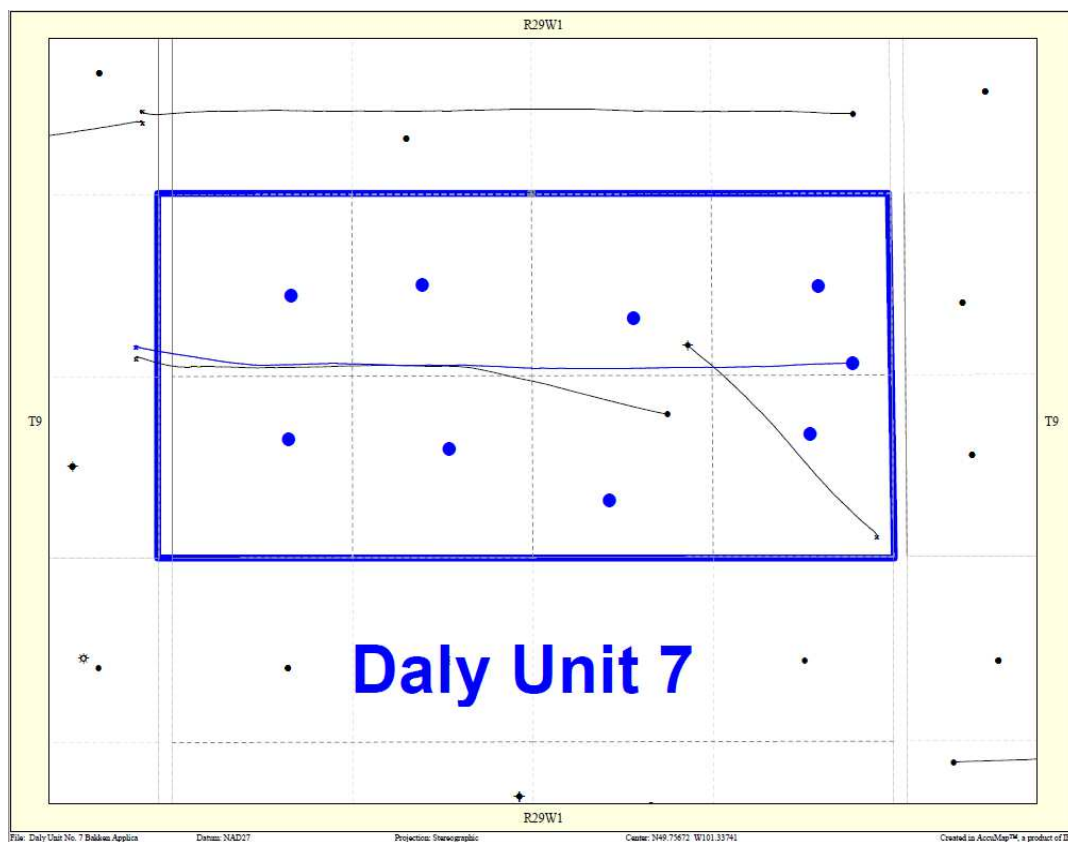

Daly Unit No. 7

Tundra Oil and Gas (Tundra), as the operator of the Daly Unit No. 7 Enhanced Oil Recovery (EOR) project hereby submits the 2017 EOR report as per section 73 of the Drilling and Production Regulations.

a) Monthly oil and water production rates, injection rate, GOR and WOR

| MONTH | Cal Dly Oil m ³ /day | Cal Dly Wtr m ³ /day | Cal Inj Wtr m ³ /day | WOR m ³ /m ³ | GOR m ³ /m ³ |
|----------|------------------------------------|------------------------------------|------------------------------------|---------------------------------------|---------------------------------------|
| Jan-2017 | 6.24 | 15.25 | 0.00 | 2.44 | 0 |
| Feb-2017 | 6.12 | 15.30 | 0.00 | 2.50 | 0 |
| Mar-2017 | 4.58 | 8.15 | 0.00 | 1.78 | 0 |
| Apr-2017 | 5.94 | 8.46 | 0.00 | 1.42 | 0 |
| May-2017 | 6.25 | 19.02 | 0.00 | 3.04 | 0 |
| Jun-2017 | 6.40 | 18.97 | 0.00 | 2.97 | 0 |
| Jul-2017 | 5.51 | 15.74 | 0.00 | 2.86 | 0 |
| Aug-2017 | 5.10 | 17.86 | 0.00 | 3.50 | 0 |
| Sep-2017 | 5.43 | 18.93 | 0.00 | 3.48 | 0 |
| Oct-2017 | 5.38 | 18.22 | 0.00 | 3.38 | 0 |
| Nov-2017 | 5.24 | 17.40 | 0.00 | 3.32 | 0 |
| Dec-2017 | 4.86 | 15.32 | 0.00 | 3.15 | 0 |

b) Cumulative volume of oil, gas and water produced and fluid injected

| 2017 PRODUCTION | |
|----------------------------------|--------|
| Produced Oil (m ³) | 2,037 |
| Produced Gas (m ³) | 0 |
| Produced Water (m ³) | 5,737 |
| Fluid Injected (m ³) | 0 |
| CUMULATIVE PRODUCTION | |
| Produced Oil (m ³) | 37,526 |
| Produced Water (m ³) | 52,877 |

Daly Unit No. 7

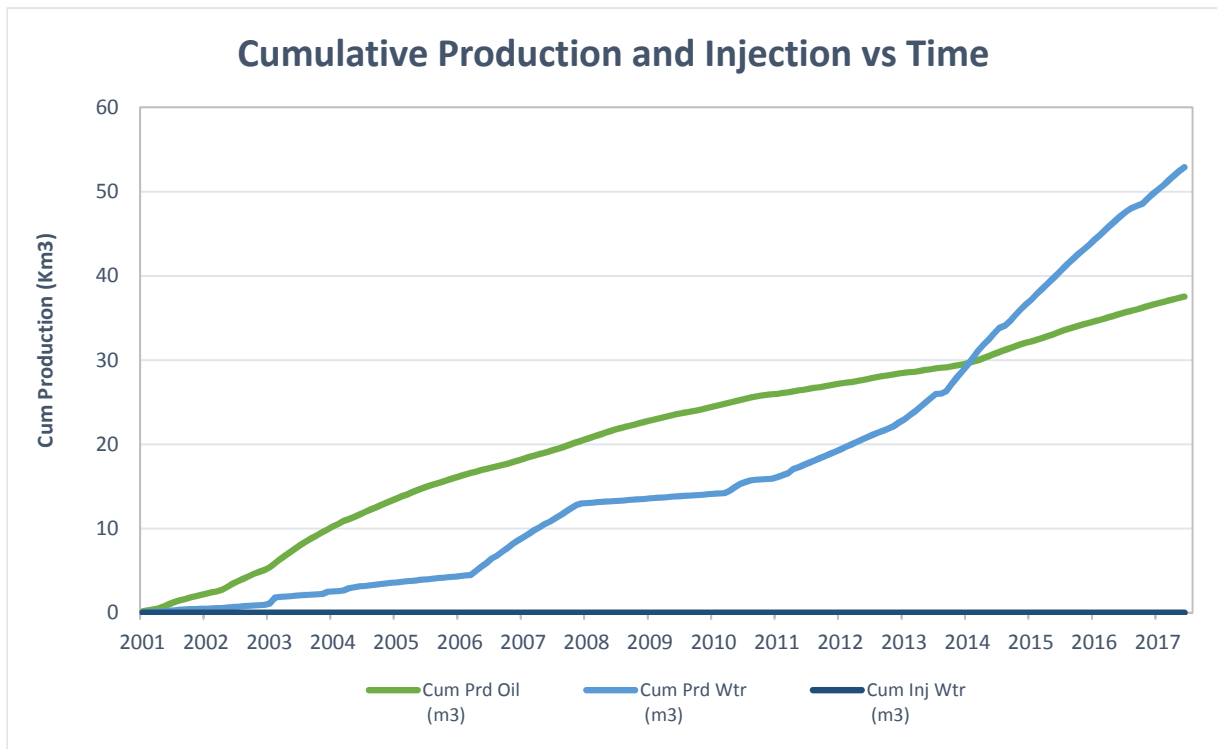

| <i>UWI</i> | <i>Type</i> | <i>Status</i> | <i>Future Plans</i> |
|----------------------|--------------------|----------------------|----------------------------|
| 100/01-22-009-29W1/2 | Vertical | Producing | - |
| 100/02-22-009-29W1/0 | Vertical | Producing | - |
| 100/03-22-009-29W1/2 | Vertical | Producing | - |
| 100/04-22-009-29W1/2 | Vertical | Producing | - |
| 100/05-22-009-29W1/0 | Vertical | Producing | - |
| 100/06-22-009-29W1/2 | Vertical | Pumping | - |
| 102/07-22-009-29W1/2 | Vertical | Producing | - |
| 100/08-22-009-29W1/2 | Vertical | Producing | - |
| 102/08-22-009-29W1/0 | Horizontal | Producing | WIW Conversion |