

Goodlands Unit No. 3

Waterflood Progress Report 2017

January 1st through December 31st 2017

Prepared for:

Manitoba Industry, Economic Development and Mines

Petroleum Branch

Prepared by:

Tundra Oil and Gas

July 30, 2018

INTRODUCTION

Goodlands Unit No. 3 Enhanced Oil Recovery (EOR) Waterflood Project was approved August 1, 2017. Goodlands Unit No. 3 area contains 35 vertical wells (14 abandoned, 21 producing), 3 deviated producing wells and 75 horizontal wells (5 abandoned/suspended, 70 producing) in 50 Legal Sub Divisions (LSD) in Township 1, Range 24 W1 as shown in the figure below.

This unit is currently not on injection.

Figure 1: Goodlands Unit No. 3 Area Outline

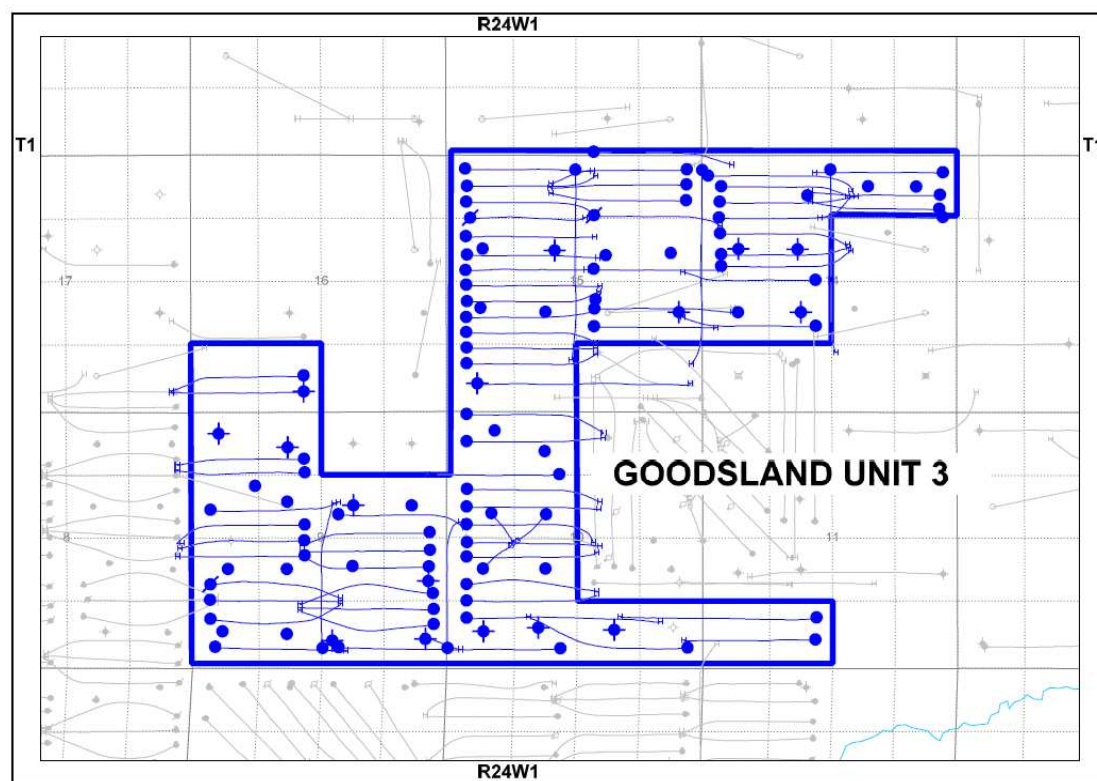

Goodlands Unit No. 3

Tundra Oil and Gas (Tundra), as the operator of the Goodlands Unit No. 3 Enhanced Oil Recovery (EOR) project hereby submits the 2017 EOR report as per section 73 of the Drilling and Production Regulations.

a) Monthly oil and water production rates, injection rate, GOR and WOR

MONTH	Cal Dly Oil m ³ /day	Cal Dly Wtr m ³ /day	Cal Inj Wtr m ³ /day	WOR m ³ /m ³	GOR m ³ /m ³
Jan-2017	52.00	319.93	0.00	6.15	0
Feb-2017	55.15	335.85	0.00	6.09	0
Mar-2017	53.69	311.12	0.00	5.79	0
Apr-2017	51.38	304.66	0.00	5.93	0
May-2017	51.45	316.49	0.00	6.15	0
Jun-2017	50.90	372.48	0.00	7.32	0
Jul-2017	50.47	358.58	0.00	7.10	0
Aug-2017	48.31	350.50	0.00	7.25	0
Sep-2017	45.50	332.46	0.00	7.31	0
Oct-2017	44.67	321.39	0.00	7.20	0
Nov-2017	45.79	307.48	0.00	6.72	0
Dec-2017	42.43	293.92	0.00	6.93	0

b) Cumulative volume of oil, gas and water produced and fluid injected

2017 PRODUCTION	
Produced Oil (m ³)	17,985
Produced Gas (m ³)	0
Produced Water (m ³)	119,346
Fluid Injected (m ³)	0
CUMULATIVE PRODUCTION	
Produced Oil (m ³)	517,603
Produced Water (m ³)	1,188,215

Goodlands Unit No. 3

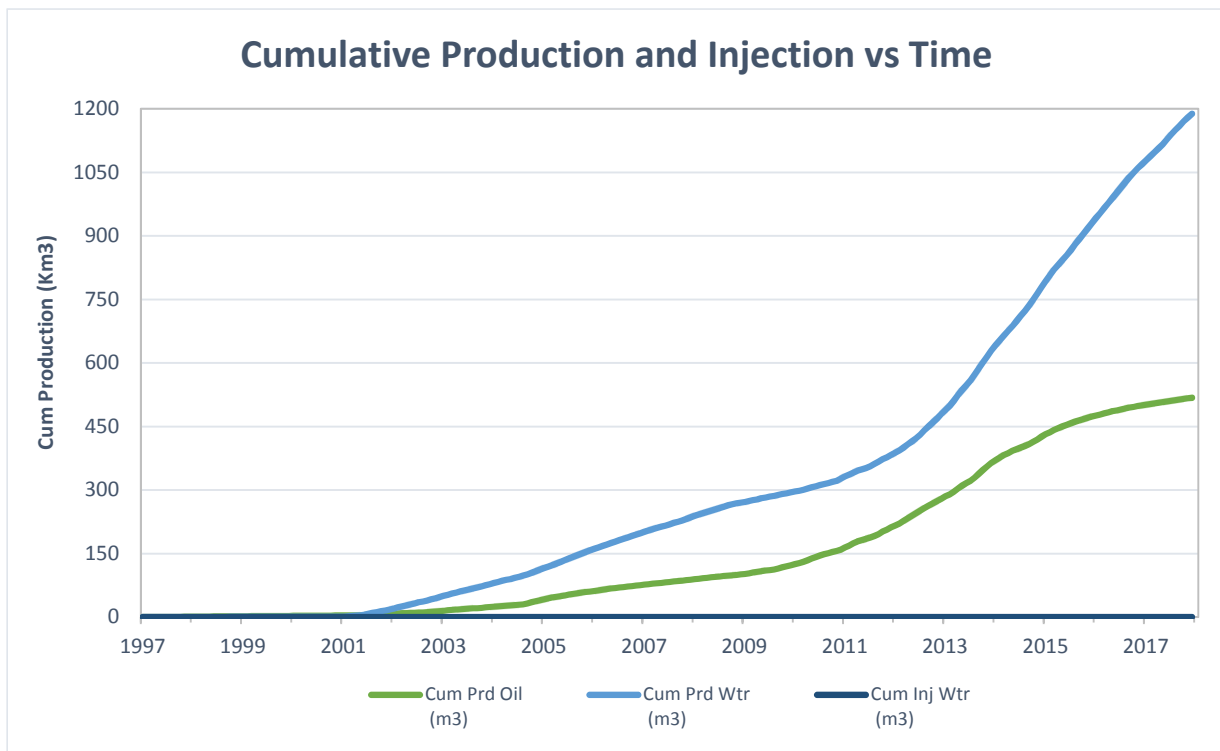

<i>UWI</i>	<i>Type</i>	<i>Status</i>	<i>Future Plans</i>
100/01-09-001-24W1/0	Vertical	Abandoned Zone	-
102/01-09-001-24W1/0	Horizontal	Producing	-
103/01-09-001-24W1/0	Horizontal	Producing	-
104/01-09-001-24W1/0	Horizontal	Producing	-
100/02-09-001-24W1/0	Vertical	Abandoned Zone	-
102/02-09-001-24W1/0	Horizontal	Producing	-
103/02-09-001-24W1/0	Horizontal	Producing	-
100/03-09-001-24W1/0	Vertical	Producing	-
100/04-09-001-24W1/0	Vertical	Producing	-
102/04-09-001-24W1/0	Horizontal	Producing	-
103/04-09-001-24W1/0	Horizontal	Producing	-
100/05-09-001-24W1/0	Vertical	Producing	-
102/05-09-001-24W1/0	Horizontal	Producing	-
103/05-09-001-24W1/0	Horizontal	Suspended	-
100/06-09-001-24W1/0	Vertical	Producing	-
102/06-09-001-24W1/0	Horizontal	Producing	-
103/06-09-001-24W1/2	Horizontal	Producing	-
100/07-09-001-24W1/0	Vertical	Producing	-
100/08-09-001-24W1/0	Vertical	Abandoned Zone	-
102/08-09-001-24W1/0	Horizontal	Producing	-
103/08-09-001-24W1/0	Horizontal	Producing	-
104/08-09-001-24W1/0	Horizontal	Producing	-
100/09-09-001-24W1/0	Vertical	Producing	-
102/09-09-001-24W1/0	Horizontal	Producing	-
100/10-09-001-24W1/0	Vertical	Abandoned Zone	-
102/10-09-001-24W1/0	Horizontal	Producing	-
100/11-09-001-24W1/0	Vertical	Producing	-
102/11-09-001-24W1/0	Horizontal	Producing	-
100/12-09-001-24W1/0	Vertical	Producing	-
102/12-09-001-24W1/0	Horizontal	Producing	-
100/13-09-001-24W1/0	Vertical	Abandoned Zone	-
100/14-09-001-24W1/0	Vertical	Abandoned Zone	-
102/14-09-001-24W1/0	Horizontal	Producing	-
103/14-09-001-24W1/0	Horizontal	Producing	-
102/01-10-001-24W1/0	Horizontal	Producing	-
100/02-10-001-24W1/0	Vertical	Abandoned Zone	-
100/03-10-001-24W1/0	Vertical	Abandoned Zone	-
102/03-10-001-24W1/0	Horizontal	Producing	-
100/04-10-001-24W1/0	Vertical	Abandoned Zone	-
102/04-10-001-24W1/0	Horizontal	Producing	-
103/04-10-001-24W1/0	Horizontal	Producing	-
100/05-10-001-24W1/0	Dir/Dev	Producing	-
102/05-10-001-24W1/0	Horizontal	Producing	-
103/05-10-001-24W1/0	Horizontal	Producing	-
105/05-10-001-24W1/0	Horizontal	Producing	-

<i>UWI</i>	<i>Type</i>	<i>Status</i>	<i>Future Plans</i>
100/06-10-001-24W1/0	Vertical	Pumping	-
100/11-10-001-24W1/0	Dir/Dev	Producing	-
102/11-10-001-24W1/0	Horizontal	Producing	-
100/12-10-001-24W1/0	Dir/Dev	Pumping	-
102/12-10-001-24W1/0	Horizontal	Producing	-
103/12-10-001-24W1/0	Horizontal	Producing	-
104/12-10-001-24W1/0	Horizontal	Producing	-
100/13-10-001-24W1/0	Vertical	Producing	-
102/13-10-001-24W1/0	Horizontal	Producing	-
103/13-10-001-24W1/0	Horizontal	Producing	-
100/14-10-001-24W1/0	Vertical	Producing	-
100/03-11-001-24W1/0	Horizontal	Producing	-
102/03-11-001-24W1/0	Horizontal	Producing	-
100/05-14-001-24W1/0	Vertical	Pumping	-
100/06-14-001-24W1/0	Vertical	Abandoned Zone	-
102/06-14-001-24W1/0	Horizontal	Producing	-
100/11-14-001-24W1/0	Vertical	Abandoned Zone	-
102/11-14-001-24W1/0	Horizontal	Producing	-
100/12-14-001-24W1/0	Vertical	Abandoned Zone	-
102/12-14-001-24W1/0	Horizontal	Producing	-
103/12-14-001-24W1/0	Horizontal	Producing	-
104/12-14-001-24W1/0	Horizontal	Producing	-
100/13-14-001-24W1/0	Horizontal	Producing	-
102/13-14-001-24W1/0	Horizontal	Producing	-
103/13-14-001-24W1/0	Horizontal	Producing	-
104/13-14-001-24W1/0	Horizontal	Producing	-
100/14-14-001-24W1/0	Vertical	Producing	-
102/14-14-001-24W1/0	Horizontal	Producing	-
100/15-14-001-24W1/0	Vertical	Producing	-
100/16-14-001-24W1/0	Vertical	Producing	-
102/16-14-001-24W1/0	Horizontal	Producing	-
103/16-14-001-24W1/0	Horizontal	Producing	-
104/16-14-001-24W1/0	Horizontal	Producing	-
105/16-14-001-24W1/0	Horizontal	Producing	-
100/04-15-001-24W1/0	Horizontal	Abandoned Zone	-
102/04-15-001-24W1/0	Horizontal	Producing	-
103/04-15-001-24W1/0	Horizontal	Producing	-
100/05-15-001-24W1/0	Vertical	Producing	-
102/05-15-001-24W1/0	Horizontal	Producing	-
103/05-15-001-24W1/0	Horizontal	Producing	-
104/05-15-001-24W1/0	Horizontal	Producing	-
105/05-15-001-24W1/0	Horizontal	Producing	-
100/06-15-001-24W1/0	Vertical	Producing	-
100/07-15-001-24W1/0	Vertical	Producing	-
102/07-15-001-24W1/0	Horizontal	Producing	-
103/07-15-001-24W1/0	Horizontal	Producing	-

<i>UWI</i>	<i>Type</i>	<i>Status</i>	<i>Future Plans</i>
100/08-15-001-24W1/0	Vertical	Abandoned Zone	-
100/09-15-001-24W1/0	Vertical	Producing	-
100/10-15-001-24W1/0	Vertical	Pumping	-
102/10-15-001-24W1/0	Horizontal	Producing	-
100/11-15-001-24W1/0	Vertical	Abandoned Zone	-
100/12-15-001-24W1/0	Vertical	Producing	-
102/12-15-001-24W1/0	Horizontal	Suspended	-
103/12-15-001-24W1/0	Horizontal	Producing	-
104/12-15-001-24W1/0	Horizontal	Producing	-
105/12-15-001-24W1/0	Horizontal	Producing	-
100/13-15-001-24W1/0	Horizontal	Producing	-
102/13-15-001-24W1/0	Horizontal	Producing	-
103/13-15-001-24W1/0	Horizontal	Producing	-
100/14-15-001-24W1/0	Horizontal	Producing	-
100/15-15-001-24W1/0	Horizontal	Suspended	-
100/16-15-001-24W1/0	Horizontal	Producing	-
102/16-15-001-24W1/0	Horizontal	Producing	-
103/16-15-001-24W1/0	Horizontal	Producing	-
104/16-15-001-24W1/0	Horizontal	Producing	-
100/03-16-001-24W1/0	Horizontal	Abandoned Zone	-
102/03-16-001-24W1/0	Horizontal	Producing	-
102/02-22-001-24W1/0	Horizontal	Producing	-