

Inland Port Special Planning Area Under The Authority of The Planning Act

Notice of Joint Public Hearing

On the date and at the time and location shown below, a JOINT PUBLIC HEARING will be held to receive representations from any person(s) who wish to make them in respect to the following matters:

**To SUBDIVIDE fifty-seven +/- 1.23 to 2.45 acre parcels
totalling +/- 145.7 acres
from the NE ¼ 34-11-2 EPM in the
RURAL MUNICIPALITY OF ROSSER and
to RE-ZONE the parcels
from INLAND PORT RURAL ZONE
to "I2" INDUSTRIAL GENERAL ZONE,
being INLAND PORT SPECIAL PLANNING AREA BY-LAW 2-19,
being an AMENDMENT to the
INLAND PORT SPECIAL PLANNING AREA REGULATION 48/2016**

HEARING LOCATION: Victoria Inn Hotel and Convention Centre
1808 Wellington Avenue,
Winnipeg

DATE and TIME: Thursday, December 12, 2019
at 6:00 p.m.

GENERAL INTENT and PURPOSE: To subdivide and re-zone the NE ¼ 34-11-2 EPM in the RM of Rosser CentrePort lands from Inland Port Rural Zone to "I2" Industrial General Zone to establish a general industrial use.

AREA AFFECTED: This subdivision and by-law shall apply to the area identified on the map of the Hearing Notice.

FOR MORE INFORMATION CONTACT: Kari Schulz, Planner
Manitoba Municipal Relations
Inland Port Special Planning Area
604-800 Portage Avenue, Winnipeg, MB R3G 0N4
Phone: 204-945-2146, Fax: 204-948-4042
Email: inlandportspa@gov.mb.ca

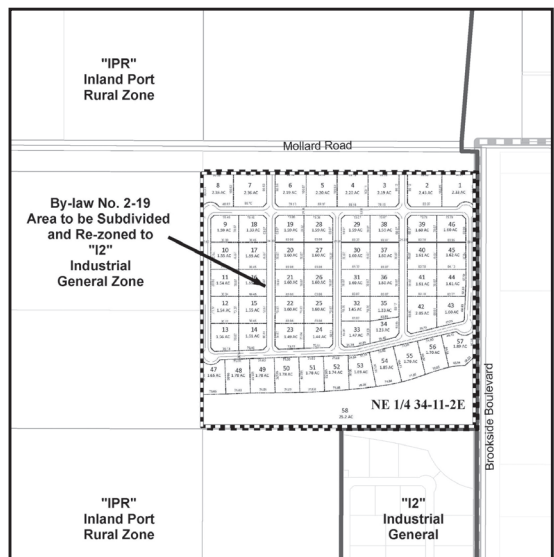

A copy of the above proposal and supporting material may be inspected at the location noted above during normal office hours, Monday to Friday. Copies may be made and extracts taken therefrom, upon request. A description of the procedure to be followed at the hearing is also available at the location noted above.

