



STE. ANNE
MUNICIPALITY

Ward	5	Civic Address	46093 & 46107 Road 30E	Application Type:	Conditional Use
Zoning	Agriculture	1/4 Sec-Twp-Rge or RL	NW 30-8-6E	File #	CU# 08-20
Lot size	147.34 acres	Lot-Block-Plan	n/a	Roll Number	119300.000

Contact Information:			
Applicant:	Alvin Plett	Address: abplett@mymts.net	Phone: 204-371-5744
Owner:	Rising Hope Dairy Inc.	Address: 26060 PR 210 Linden, MB R0A 0X1	Phone: 204-355-4980

Existing:
Two Single family dwellings
Livestock (dairy) operation of 1200 AU (as approved under CU# 05-15) with multiple main and accessory buildings and earthen manure storage

Proposed:
Livestock (dairy) operation expansion up to 1500 milking and 300 dry cows / 3600 Animal Units of Waste

Zoning By-law Requirements:	Minimum Bulk Requirements	Documentation Received:
Part VI	Front Yard as determined by Council	Letter of Intent October 1, 2020
Section n/a	Side Yard as determined by Council	Building Location Certificate n/a
Table VI-5	Side Yard as determined by Council	Owners' Written Consent
Planning Act Section Part 7	Rear Yard as determined by Council	to be received
	Site Area 50 acres	
	Site Width as determined by Council	
Other:		

Notes:

Application Fees: \$1,750.00	Receipt # 20203986	Date: November 20, 2020
------------------------------	--------------------	-------------------------

DECLARATION

I, the undersigned, am the authorized agent/owner named in this application. I hereby certify that the information provided on this form and attachments hereto, to be the best of my knowledge is a true statement of facts concerning this application.

Print name: Alvin Plett

Signature of Applicant: *Alvin Plett* Date: *Nov 19, 20*

Office Use Only - Proposed Hearing Date:

To whom it may concern at the Ste Anne Municipal Office,
I, Connie Plett, endorse my father in law, Alvin Plett,
and/or Kevin Plett, my husband, to handle the paperwork
for Rising Hope Dairy Inc. in regards to our expansion plans
and conditional use permit application at Rising Hope.

Thank you,

Connie Plett

Connie Plett

Date: Nov. 19/20

R.M. OF STE. ANNE
 395 TRAVERSE ROAD BOX 6, GRP 50, RR 1
 STE. ANNE MB R5H 1R1
 (204) 422-5929

OFFICIAL RECEIPT

Page 1 of 1
RECEIPT #
20203986
DATE OF ISSUE
2020-11-20
9:30:30AM
POSTING DATE
2020-11-20

RISING HOPE DAIRY INC.
 26060 PR 210
 LINDEN, MB
 R0A 0X1
 CANADA

ACCOUNT #	DESCRIPTION	PREV BAL	PAYMENT	BALANCE	GST	PST
1008450350000 GL	CU #08-20 RISING HOPE DAIRY		1,750.00			
CHEQUE (018)		1,750.00				
			PST	\$0.00	Received By trb Batch # 12461	
			GST REG. # 107943615RP0001	\$0.00		
			LEVY	\$0.00		
			TOTAL AMOUNT RECEIVED	\$1,750.00		

COPY OF RECEIPT WAS EMAILED TO:
 development@rmofsteanne.com

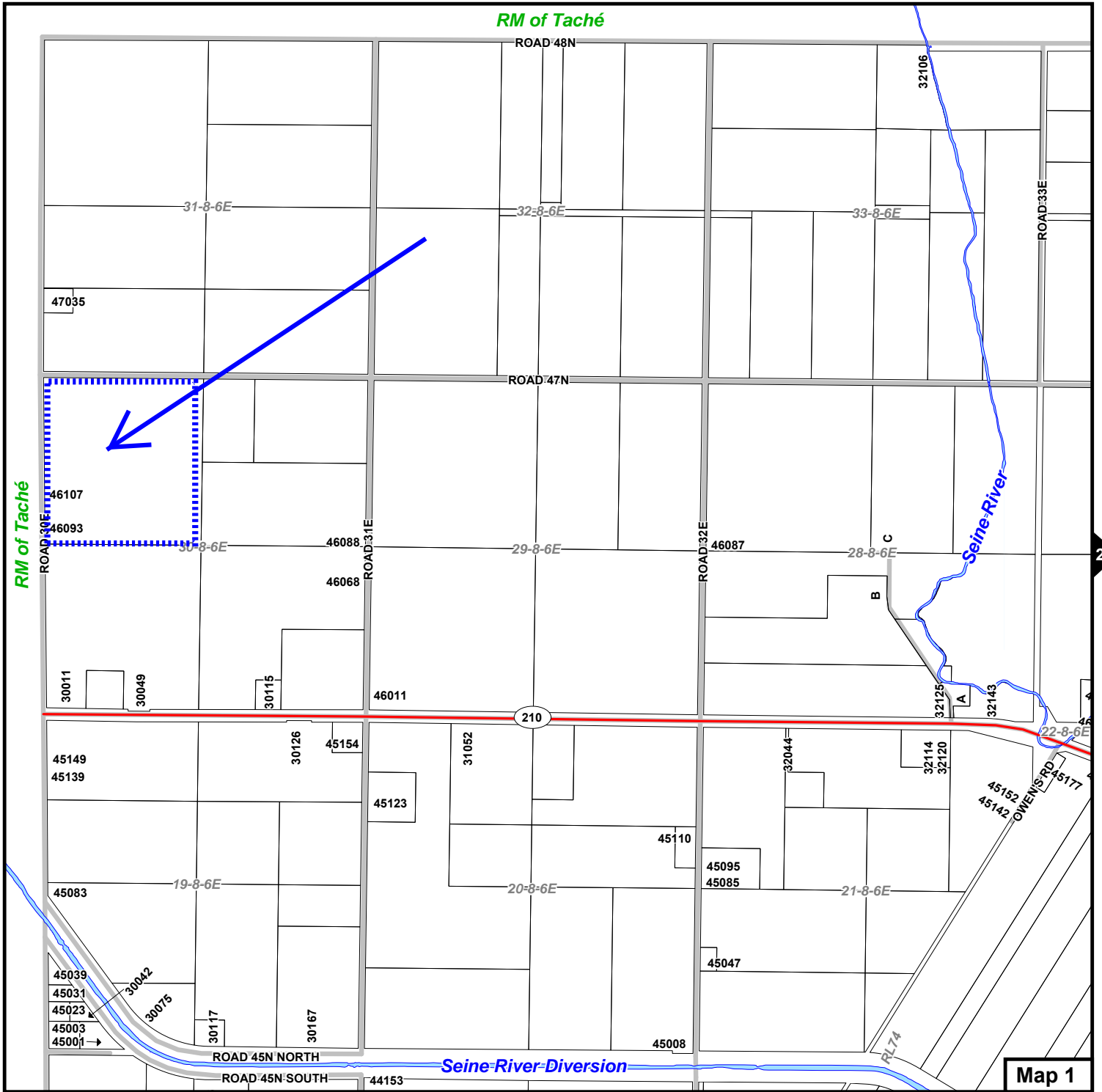

Map 1



NW 30-8-6E
R.M. of Ste. Anne

1 Site Layout
B1 N.T.S.



Penfor Construction
 Box 20 Blumenort, Manitoba R0A 0C0
 Phone: (204) 326-6313; Fax: (204) 346-1313

Project Name and Address
Rising Hope
 Proposed Dairy Rotary Barn
 Landmark, MB

Drawing Title
Site Layout

Date	Drawn By	Sheet
Oct 07, 2020	--	B1
Scale	Checked By	
as noted	RD	