

21.0 Truck Haul and Seasonal Use Routes

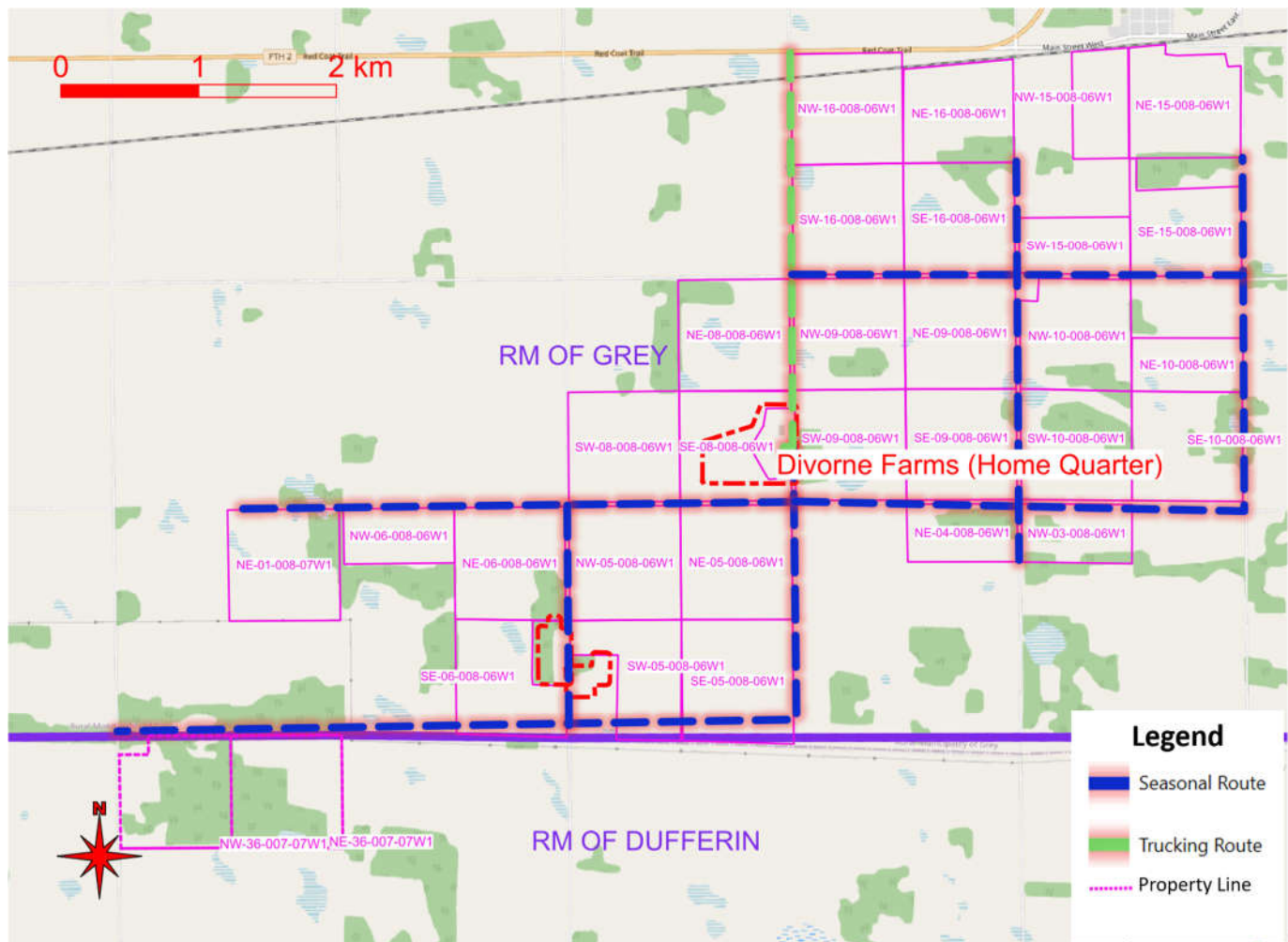

Figure 13: Truck and Seasonal Routes

Note: Trucking Route is used all year round for both farm access for commercial and personal vehicles and for the seasonal movement of equipment including that used for manure distribution, cropping and harvesting purposes. Seasonal Routes are those used only for manure distribution, cropping, and harvesting purposes.

Solid manure is moved only to the fields in closest proximity to both Site 1 and Site 2 with minimal road use. Liquid manure at Site 1 is moved to field via a drag hose system with minimal road use.

Divorner farms harvests approximately 776 loads of Alfalfa annually at 8 tonnes/load and 912 loads of corn silage at 12 tonnes/load.