



**Environment, Climate and Parks**

Environmental Approvals Branch  
1007 Century Street, Winnipeg MB R3H 0W4  
T 204-945-8321 F 204-045-5229  
[www.manitoba.ca](http://www.manitoba.ca)

Registry File Number: 6000.00  
File No.: 18414

November 21, 2022

Denise Parent,  
Chief Administrative Officer  
Rural Municipality of De Salaberry  
Box 40, St. Pierre Jolys MB R0A 1V0  
[cao@rmdesalaberry.mb.ca](mailto:cao@rmdesalaberry.mb.ca)

Dear Denise Parent:

**Re: Rural Municipality of De Salaberry - Waste Disposal Ground Permit No. 49464 P1**

Thank you for your proposal. Enclosed Permit No. 49464 P1 is issued to the Rural Municipality of De Salaberry to run its Waste Disposal Ground.

The Rural Municipality of De Salaberry must follow all permit requirements and federal, provincial, and municipal regulations and by-laws.

Anyone affected by the issuance of this permit may appeal the decision to the Minister of Environment, Climate and Parks. Appeals must be submitted in writing to the Minister at [minecp@leg.gov.mb.ca](mailto:minecp@leg.gov.mb.ca) by December 21, 2022.

If you have questions about this approval, please contact Allan Cyrenne, Acting Regional Supervisor, Environmental Compliance and Enforcement Branch at [EnvCEEastern@gov.mb.ca](mailto:EnvCEEastern@gov.mb.ca) or 204-485-6410.

Sincerely,

Original Signed by  
James Capotosto  
Director

Enclosure

c. Allan Cyrenne

# Waste Disposal Ground Operating Permit



**File No. : 18414**

**Permit No.: 49464 P1**

**Issue Date: November 21, 2022**

Following the Waste Management Facilities Regulation under The Environment Act, the Rural Municipality of De Salaberry is hereby permitted to run the Rural Municipality of De Salaberry Waste Disposal Ground (facility) on portions of NE 14-5-4 EPM within the Rural Municipality of De Salaberry, Province of Manitoba. Schedule A of this permit identifies the facility.

This permit is subject to being amended, suspended, or revoked under sections 7 and 9 of the Waste Management Facilities Regulation.

This permit is issued subject to the following terms and conditions:

## **General Terms and Operating Conditions**

1. This permit expires on November 16, 2027.
2. The operator must maintain and operate the facility following the Waste Management Facilities Regulation and any future amendments thereof, and this permit.
3. The operator must obtain approval in writing from the director of the Environmental Approvals Branch before altering the facility.

## **Materials Acceptance and Handling**

4. The operator must segregate materials collected for recycling or reuse, and must temporarily stockpile these materials in clearly signed designated areas. These areas must be maintained to control weeds, vectors, and the quality of the materials.
5. The operator must remove the materials identified in clause 4 of this permit regularly or upon the request of an environment officer, within the timeframe specified.
6. The operator must remove any litter accumulated along the access road and around the perimeter of the site at minimum twice annually or as required by an environment officer.
7. The operator must dispose of asbestos or asbestos containing material following the most current version of Manitoba's Guideline for Asbestos Disposal at a Landfill.
8. The operator:
  - a) may accept less than ten tonnes of dead animals from a single source or event at the facility provided that they are buried immediately with a minimum one metre cover or as approved by an environment officer;
  - b) may accept more than ten tonnes of dead animals upon receiving written approval from an environment officer; and
  - c) must handle dead animals when identified as specified risk material following the Canadian Food Inspection Agency requirements.

### **Hazardous Wastes**

9. The operator must collect and dispose of any hazardous waste following The Dangerous Goods Handling and Transportation Act, and other federal, provincial, and municipal regulations.

### **Placement and Cover**

10. The operator may use material other than soil to cover the active area upon receiving written approval from the director or environment officer.

### **Surface Water Management**

11. The operator must construct the facility such that all uncontaminated surface water flows to the perimeter ditch and impacted water from all material storage areas is contained within the facility boundaries.

### **Site Construction and Upgrading**

12. The operator must have all waste disposal cells, modifications or alterations designed by and construction overseen by an engineer.
13. The operator must, before beginning any construction at the facility, submit an electronic copy of final engineering design plans, sealed by an engineer(s), to the director. The plans will show the engineering details of each new or altered component and the location of each new or altered component with respect to other components.
14. The operator must construct the facility following the design plans submitted to the director following clause 13 of this permit and subject to any terms and conditions set by the director.
15. Notwithstanding clause 14 of this permit, construction must be subject to the following conditions:
  - a) the operator must provide for testing of all clay liners and cut-off walls by a qualified consultant to confirm that compaction is 95% Standard Proctor Density on maximum lifts of 0.15 m (150 mm); and
  - b) all active areas or leachate containment developed from or with clay must be constructed to achieve a hydraulic conductivity of not more than  $1 \times 10^{-7}$  cm/s with a minimum thickness of one metre perpendicular to the surface. If appropriate or sufficient clay is not available an alternative proposal must be submitted to the director for written approval before construction.
16. The operator must, unless otherwise approved by the designated environment officer, arrange with the environment officer a mutually acceptable time and date for any required soil sampling between the 15<sup>th</sup> day of May and the 15<sup>th</sup> day of October of any year.
17. The operator must take and test undisturbed soil samples from the following:
  - a) the clay of new waste disposal cell(s);
  - b) leachate ponds; and
  - c) any clay component of the facility requiring testing by the director.

18. The number and location of samples and test methods will be specified by the designated environment officer up to a maximum of 20 samples per cell or clay component of the facility.
19. The operator must, before using any area tested following clause 17 of this permit, receive the approval of the environment officer for the results of the tests carried out following clause 17 of this permit.
20. The operator must:
  - a) prepare record drawings of the facility and must label the drawings "record drawings"; and
  - b) submit "record drawings" along with a construction report to the director within 120 days of the completion of construction of the facility. The construction report must include the following:
    - i) engineer's inspection dates and notes;
    - ii) density measurements (for clay lined facility); and
    - iii) updated site plan showing the new cell and monitoring well installation logs, locations, and background water samples (if applicable).

#### **Burning of Specified Waste**

21. The operator must only burn:
  - a) separated and readily combustible materials such as boughs, leaves, loose straw, paper products, cardboard, non-salvageable untreated wood, and packing materials derived from wood; and
  - b) only when there is an appropriate volume of materials as identified in clause 21 (a).

#### **Composting**

22. The operator must not allow composting at the facility.

#### **Monitoring and Reporting Requirements**

23. The operator must collect, store, and analyze groundwater monitoring well samples using approved field and laboratory techniques for dissolved analysis. The analytical results must be retained in a format acceptable to the director.
24. The operator must sample the groundwater monitoring wells for those parameters identified in Schedule B of this permit once per year, or at a frequency approved by the director.
25. The operator must submit an annual report, in a format acceptable to the director, detailing the sampling methodology, field observations and results of groundwater sampling analyses, complete with previous results and trends. The report must be submitted annually to an environment officer no later than December 31 of each year.

**Revocation**

26. This permit replaces permit No. 49464, which is hereby rescinded.

Original Signed by

James Capotosto  
Director

**Schedule A to Permit No. 49464 P1  
Facility Layout**

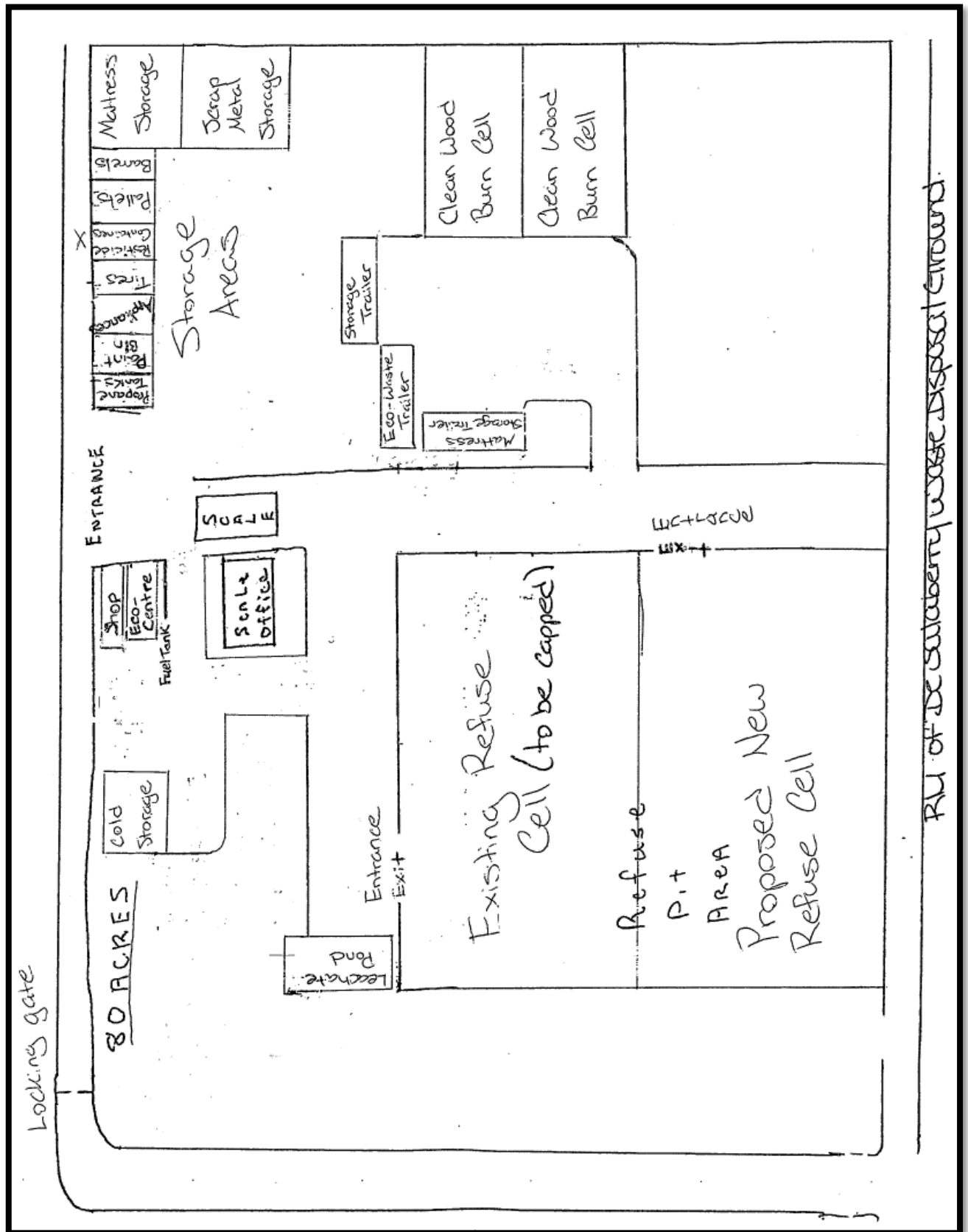

**Schedule B to Permit No. 49464 P1**  
**Ground Water Chemistry Parameters Following Clause 24 of This Permit**

<b>Chemical Parameters</b>		
<b>Inorganics</b>		
Alkalinity – Total		Magnesium – Dissolved
Ammonia – Total		Manganese – Dissolved
Arsenic – Total		Mercury – Dissolved
Barium – Dissolved		Nitrate - Reported as N
Boron – Dissolved		Nitrite - Reported as N
Cadmium – Dissolved		Total Kjeldahl Nitrogen – Reported as N
Calcium – Dissolved		Total Phosphorous
Calcium Carbonate		Potassium – Dissolved
Chloride		Silicon – Dissolved
Chromium – Dissolved		Sodium – Dissolved
Conductivity		Total Dissolved Solids (TDS)
Copper – Dissolved		Sulphate
Iron – Dissolved		Uranium – Dissolved
Lead – Dissolved		Zinc – Dissolved
<b>Volatile Organic Compounds (VOC's)</b>		
BTEX		
<b>Other Organics</b>		
Biological Oxygen Demand (BOD)		Chemical Oxygen Demand (COD)
Dissolved Organic Carbon (DOC)		
<b>Field Parameters</b>		
pH		Groundwater Elevation
Conductivity		Dissolved Oxygen
Temperature		

Note: The director may revise this schedule. All dissolved samples should be filtered in the field and preserved in the field at time of sampling. The operator must notify the director and the laboratory for dissolved samples not filtered and preserved in the field.