



Environment and Climate Change

Environmental Approvals Branch
Box 35, 14 Fultz Boulevard
Winnipeg MB R3Y 0L6
T 204 945-8321 F 204 945-5229
EABDirector@gov.mb.ca

Public Registry File Number: 6000.00
File Number: 73074

November 1, 2023

Theresa Bergen
Chief Administrative Officer
Municipality of North Norfolk
Box 190
MacGregor MB R0H 0R0
office@northnorfolk.ca

Dear Theresa Bergen:

Re: Municipality of North Norfolk – Sprucedale Recycling Permit No. 55200 P2

Please find enclosed Permit No. 55200 P2 in response to your proposal dated June 16, 2023. You wish to continue operating the Sprucedale Recycling at 17 Bishop St., Austin, Manitoba within the Municipality of North Norfolk.

The Municipality of North Norfolk must follow all permit requirements and federal, provincial, and municipal regulations and by-laws.

Anyone affected by this decision may appeal, in writing, to the Minister of Environment and Climate Change at minec@leg.gov.mb.ca by December 1, 2023. The permit is available on the public registry at <https://www.gov.mb.ca/sd/eal/registries/6000wmfpermits/index.html>.

If you have any questions on this approval, please contact Kim Kmet, Acting Regional Supervisor, Environmental Compliance and Enforcement Branch at EnvCEPortage@gov.mb.ca or 204-641-4091.

Sincerely,

Original Signed By
Agnes Wittmann
Director
The Environment Act

Enclosure

c. Tyler Kneeshaw
Kim Kmet

Material Recovery Facility Operating Permit



File No. : 73074

Permit No.: **55200 P2**
Issue Date: **November 1, 2023**

Following the Waste Management Facilities Regulation under The Environment Act, the Municipality of North Norfolk is hereby permitted to run a material recovery facility to be known as Sprucedale Recycling (facility) at 17 Bishop St., Austin, Manitoba within the Municipality of North Norfolk. Schedule A of this permit identifies the facility.

This permit is subject to being amended, suspended, or revoked under sections 7 and 9 of the Waste Management Facilities Regulation.

Definitions

In this permit,

"director" means an employee so designated under The Environment Act unless otherwise specified in the permit;

"material recovery facility" means a facility where comingled recyclable materials are separated, processed or where source-separated recyclable materials are processed for sale;

"noise nuisance" means an unwanted sound, in an affected area, which is annoying, troublesome, or disagreeable to a person:

- a) residing in an affected area;
- b) working in an affected area; or
- c) present at a location in an affected area which is normally open to members of the public;

if the unwanted sound

- d) is the subject of at least five written complaints, received by the director in a form satisfactory to the director and within a 90-day period, from five different persons falling within clauses a), b), or c), who do not live in the same household; or
- e) is the subject of at least one written complaint, received by the director in a form satisfactory to the director, from a person falling within clauses a), b), or c) and the director is of the opinion that if the unwanted sound had occurred in a more densely populated area there would have been at least five written complaints received within a 90-day period, from five different persons who do not live in the same household;

"odour nuisance" means a continuous or repeated odour, smell or aroma, in an affected area, which is offensive, obnoxious, troublesome, annoying, unpleasant, or disagreeable to a person:

- a) residing in an affected area;
- b) working in an affected area; or
- c) present at a location in an affected area which is normally open to members of the public;

if the odour, smell, or aroma

- d) is the subject of at least five written complaints, received by the director in a form satisfactory to the director and within a 90-day period, from five different persons falling within clauses (a), (b), or (c), who do not live in the same household; or
- e) is the subject of at least one written complaint, received by the director in a form satisfactory to the director, from a person falling within clauses (a), (b), or (c) and the director is of the opinion that if the odour, smell, or aroma had occurred in a more densely populated area there would have been at least five written complaints received within a 90-day period, from five different persons who do not live in the same household.

"operator" means the holder of a licence or permit issued in respect of the waste management facility.

General Terms and Operating Conditions

- 1. This permit expires on November 1, 2028.
- 2. The operator must maintain and operate the facility following the Waste Management Facilities Regulation and any future amendments, and this permit.
- 3. The operator must obtain approval in writing from the director before altering the facility.

Environmental Coordinator

- 4. The operator must, within 60 days of the date of issuance of this permit, designate an employee as the operator's environmental coordinator, whose job description will include assisting the:
 - a) operator in complying with the limits, terms, and conditions in this permit; and
 - b) assisting the senior management of the operator to manage environmental issues at the facility.
- 5. The operator must submit the name of the environmental coordinator in writing to the director within 14 days of the appointment and any subsequent appointment.

Facility Access and Supervision

- 6. The operator must provide site supervision when the public can access the processing area of the facility.
- 7. The licensee must secure the facility so that:
 - a) gates are provided for all access locations to the facility; and
 - b) the gates are kept locked when an operator is not on duty or the facility is closed.

Fire Reporting

- 8. The operator must, within 90 days of the date of issuance of this permit, prepare and maintain an emergency response contingency plan following the Canadian Centre for Occupational Health and Safety "Emergency Response Planning Guide" or other emergency planning guidelines acceptable to the director.

9. The operator must in the event of a fire that continues in excess of 30 minutes, requires implementation of the emergency response plan, or requires fire suppression assistance from personnel outside of the facility (example: fire department):
 - a) call the fire department; and
 - b) report the fire by calling the environmental emergency report line at 204-944-4888 (toll free 1-855-944-4888), identifying the type of materials involved, and the location of the fire.

Odour Nuisance

10. The operator must not cause or permit an odour nuisance to be created as a result of the construction, operation, or alteration of the facility, and must take such steps as the director may specify to eliminate or mitigate an odour nuisance.

Noise Nuisance

11. The operator must not cause or permit a noise nuisance to be created as a result of the operation or alteration of the facility, and must take such steps as the director may require to eliminate or mitigate a noise nuisance.

Materials Acceptance and Handling

12. The operator must implement control measures to prevent attraction and sustenance of rodents and scavenging vectors.
13. The operator must segregate materials collected for recycling or reusing, and must temporarily stockpile these materials in clearly designated enclosed areas. The operator must maintain the facility to control weeds, vectors, and the quality of the materials.
14. The operator must remove the materials identified in clause 13 of this permit every 90 days or at a frequency required by an environment officer.
15. The operator must not store any wastes, or materials separated out during processing that are not recycled or reused, except in appropriate storage bins in a manner to prevent nuisance.
16. The operator must remove and dispose of all wastes identified in clause 15 of this permit at minimum every 30 days or at a frequency required by an environment officer.
17. The operator must remove any litter accumulated around the perimeter of the site. Litter collection must occur at minimum twice annually or as required by an environment officer.
18. The operator must not store any material outside the building except during receiving or shipping operations for a duration of not more than 48 hours unless otherwise approved by an environment officer.
19. The operator must not accept petroleum contaminated soil, industrial wastes, construction and demolition wastes, tires, or dead animals at the facility.

Solid Waste

20. The operator must undertake a general clean-up to confine solid waste to the smallest practicable area within the facility area at least once each spring and once each autumn, or more frequently if required by an environmental officer.
21. The operator must dispose of all non-hazardous solid waste collected at the facility, which is not recycled, only to a waste disposal ground operating under the authority of a permit issued according to the Waste Management Facilities Regulation or any future amendments, or a licence issued according to The Environment Act.

Retain Records and Annual Report

22. The operator must maintain records of the materials received and removed from the facility.
23. The operator must make the records as identified in clause 22 of this permit available to an environment officer upon request.
24. The operator must, on or before the 31st day of March of each year, submit to the director an annual report respecting all activities at the facility during the previous year. The report must be in a format acceptable by the director, and must contain at minimum the monthly breakdown of materials received, recycled, reused, processed, sold, removed, and/or disposed.

Closure Plan

25. The operator must, within 90 days of date of this permit, submit a preliminary closure plan of the facility for approval by the director.
26. The operator must review and update the approved closure plan every five years or more frequently as the operator's preference, or at the request of the director.
27. The operator must, at least six months before the permanent closure of the facility,
 - a) notify the director in writing of the intended closure; and
 - b) submit a final closure plan to the director for review and approval.
28. The operator must implement and maintain the closure plan as approved by the director.

Revocation

29. This permit replaces Permit No. 55200 P1, which has expired.

Original Signed By
Agnes Wittmann
Director
The Environment Act

Schedule A to Permit No. 55200 P2

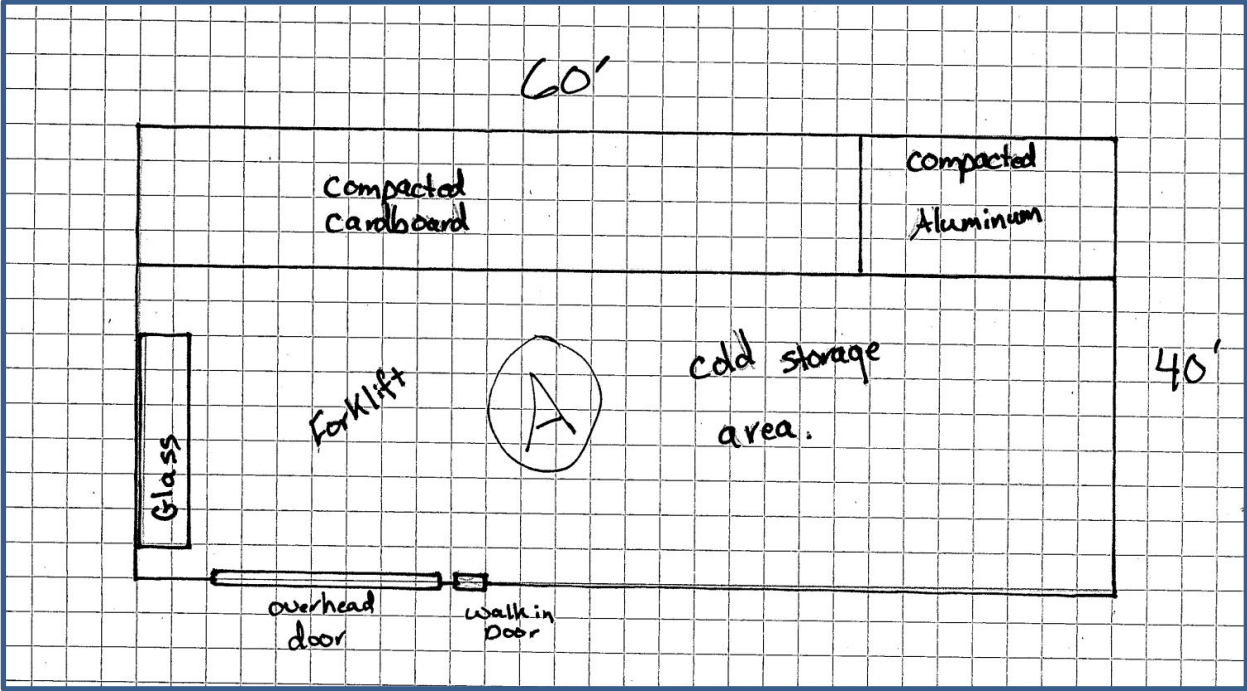

Facility Layout A - Cold Storage

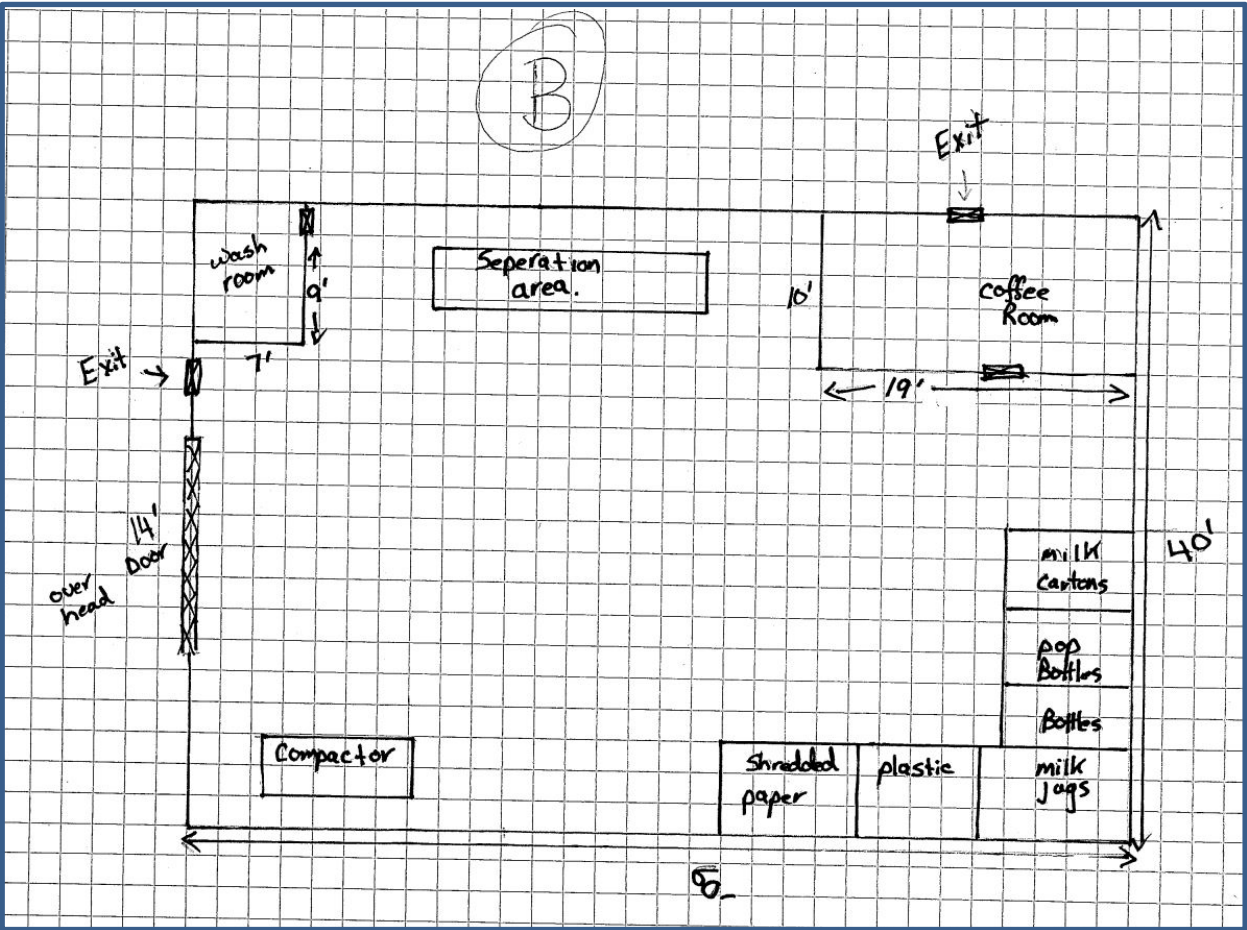

Facility Layout B - Workshop