SECTION 1.0

SECTION 1.0 INTRODUCTION

This Environment Act Proposal covers two related aspects of a proposed development in the City of Brandon: expansion of the City of Brandon's Industrial Waste Water Treatment Facility (IWWTF) and operational improvements to the Maple Leaf Pork pretreatment facility. The expansion of the IWWTF is required to accommodate the already-licensed second production shift at Maple Leaf Pork. The existing City of Brandon's Environment Act Licence (No. 2367 S2) restricts the City from accepting any influent from a second-shift operation of the pork processing facility until the City is so authorized through a Licence issued pursuant to The Environment Act. Similarly, the Maple Leaf Foods Inc.'s Licence (No. 2311 S2R) for the Pork Processing plant restricts a second-shift operation until the adjacent off-site City of Brandon Waste Water Treatment Facility is licensed to accept waste water generated by a second-shift operation and until the operator of the off-site waste water treatment facility (the City of Brandon) authorizes Maple Leaf Pork to commence production in excess of a first-shift maximum daily and maximum weekly production rates. The operational changes that will be implemented at the pretreatment plant are not a requirement of either licence nor are they required to accommodate the second-shift. Therefore, these changes will take place gradually over time as they are planned and budgeted.

1.1 OVERVIEW OF THE CITY OF BRANDON

The City of Brandon is Manitoba's second largest city and is located along the Trans Canada Highway No. 1 about 130 km east of the Saskatchewan border and 106 km north of the United States border. Brandon has a growing population that recently reached 42,242 (June, 2002). The City of Brandon originated in 1881 and now straddles the picturesque Assiniboine River valley. Initially, Brandon grew so rapidly that it never attained status as a village or town but became a city overnight. Brandon was officially incorporated as a city on May 30th, 1882.

Brandon covers an area of 43 km² (26 sq. miles) and according to the 1996 Census had a population of 39,175. However, its trading population is estimated at 180,000 as it services a large surrounding rural area including southeastern Saskatchewan. Brandon is home to the Brandon University and Assiniboine Community College. Some of the major industries and successful companies in Brandon include Maple Leaf Pork, Simplot Canada Ltd.'s fertilizer plant, Ayerst Organics Ltd., Nexen Chemicals, A.E. MacKenzie Seed Company, Behlen Industries; and, Inventronics.

1.2 MAPLE LEAF FOODS INC.

Maple Leaf Foods Inc. is Canada's largest food processing company. Built on a foundation of strong consumer brand names and an expanding private label business, the Company has improved its manufacturing base in recent years through an aggressive capital spending program and selected acquisitions. It is strategically positioned to participate in the broader free trade environment. Maple Leaf Foods, with sales of more than \$5.1 billion and 18,000 employees, trades on the Toronto stock exchange.

Maple Leaf Foods was formed in 1990 with the merger of Canada Packers and Maple Leaf Mills; companies with origins dating back to the earliest days of Canada's food industry. With strong brand and market positions, efficient low-cost manufacturing facilities; and, national distribution networks Maple Leaf Foods is a significant player in the North American food industry. Based in Toronto, Canada, the Company operates with a small corporate office over-seeing individual businesses, which operate in a stand-alone decentralized culture.

Maple Leaf Pork in Brandon is an important element of Maple Leaf Foods' presence in western Canada. Maple Leaf Pork is an unincorporated division of Maple Leaf Meats Inc., which is owned by Maple Leaf Foods Inc.

With the current free trade environment, each business has a focus to build sales into the United States markets from its Canadian plants by leveraging its competitive cost structure to support its wide range of quality products. Through its established and highly successful international trading business, Maple Leaf Foods continues to expand its global trading, resulting in international sales to about one billion dollars annually. Maple Leaf Pork in Brandon is currently shipping pork products to 54 countries worldwide (Personal Communication – Gord Maxwell, Vice President, Manufacturing, Brandon, Maple Leaf Pork).

1.3 GENERAL DESCRIPTION

This development proposal is for the commissioning and operation of the City of Brandon's expanded Industrial Waste Water Treatment Facility (IWWTF); and, it also describes some planned operational improvements to the existing waste water pretreatment facility as part of Maple Leaf Foods Inc.'s ongoing program of preparation for the second-shift at its Pork Processing Plant. The existing waste water pretreatment plant is part of the Maple Leaf Pork Processing Plant and is connected in series between the Processing Plant and the existing IWWTF. An additional Zenon membrane component system will be added in parallel to the existing IWWTF, as well as a flow equalization basin in front of the membrane system. Figure 1.1 shows the existing and expanded facility location within the province and within the City of Brandon. This Environmental Impact Assessment document is being submitted to address the construction and operating impacts of the expanded IWWTF. This is in

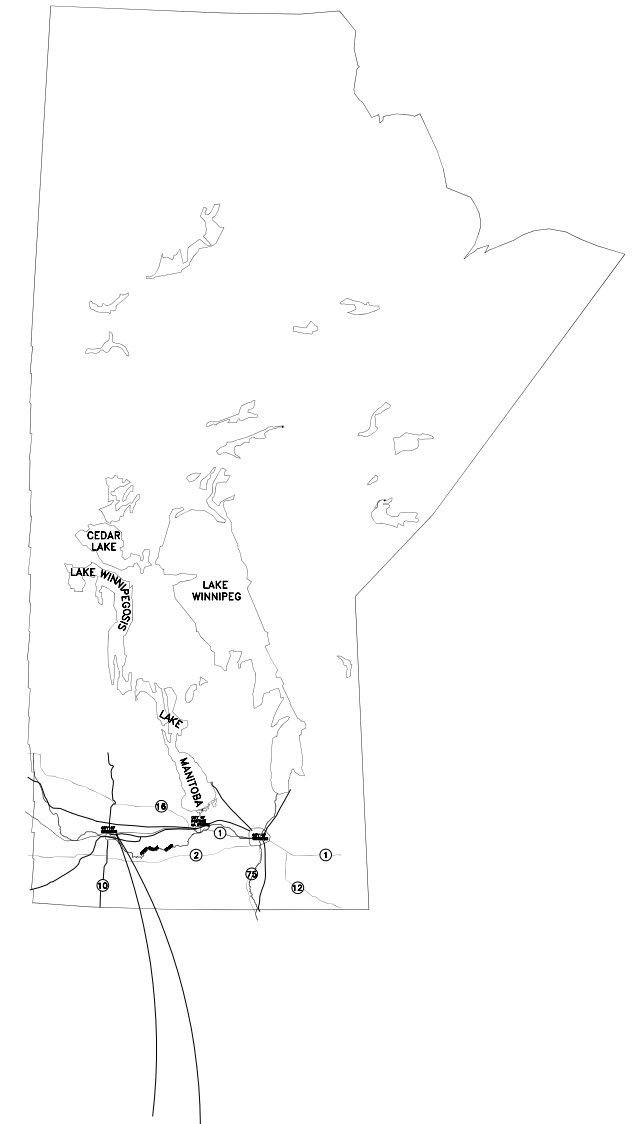
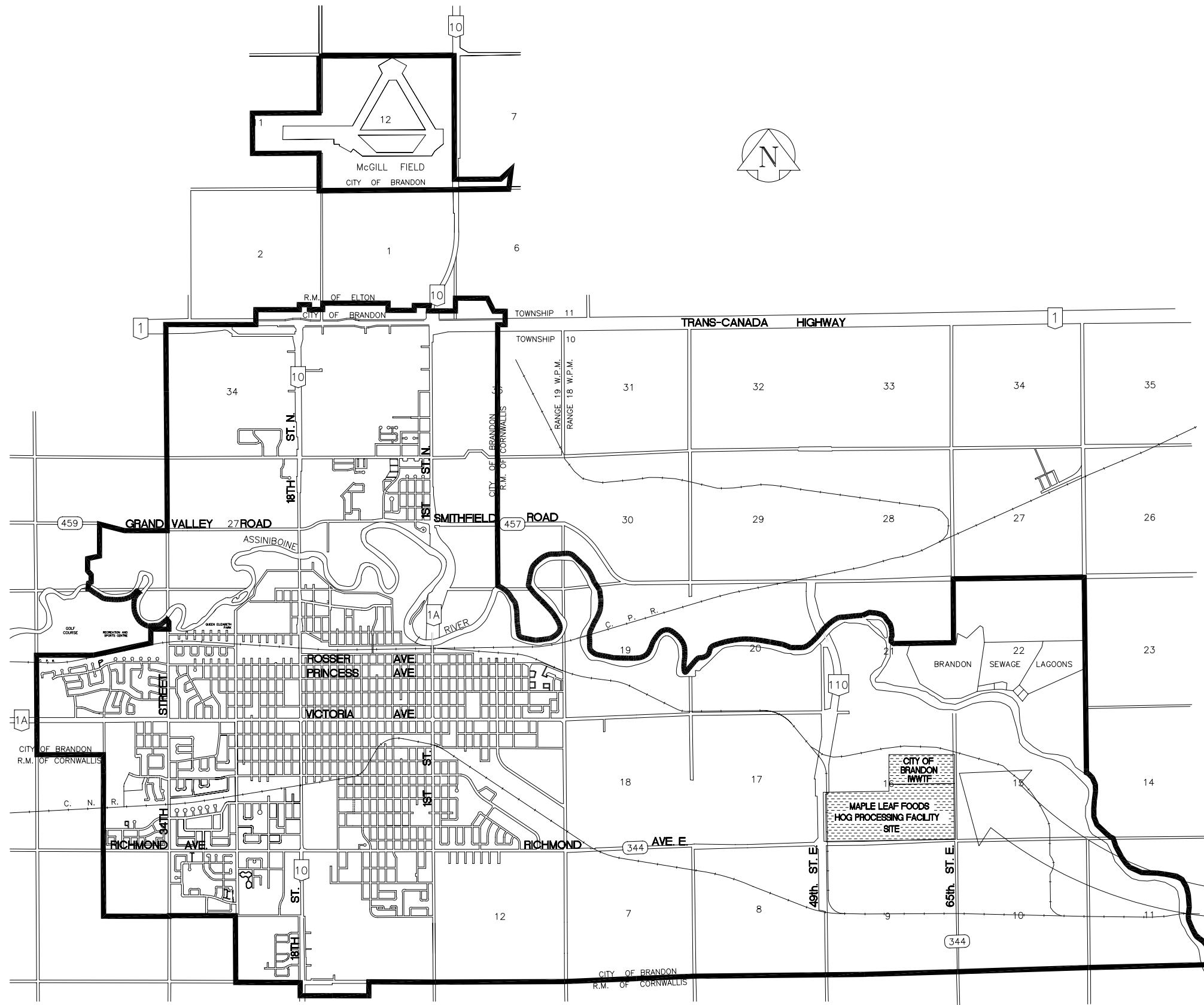

SITE LOCATION

no.	yyyy/mm/dd	revision	by	app.

EARTH TECH
 A **tyco** INTERNATIONAL LTD. COMPANY
 Earth Tech (Canada) Inc. Winnipeg, Manitoba 204.477.5381

**Location Plan of The City of Brandon
 Expanded IWWT**

designed CB	scale N.T.S.	yyyy/mm/dd 2003/03/12
drawn CB	project no. 57730	
checked SJB	drawing no. 1.1	rev.
approved KMA		

accordance with the Advice Document issued by Manitoba Conservation for the project on June 10, 2002. This Advice Document is available at:

<http://www.gov.mb.ca/conservation/envapprovals/publs/mlf-advice.html>.

Maple Leaf Meats, Inc. was the proponent of the first-shift process waste water treatment facility, and through negotiations with the City of Brandon it was decided the City would be the applicant, owner and holder of the Manitoba Environment Act Licence. Maple Leaf Meats has since become an unincorporated division of Maple Leaf Foods Inc. Although Maple Leaf Meats, Inc. was initially to be the owner and operator of the original IWWTF, the City of Brandon assumed this responsibility since it had the personnel and experience to operate waste water treatment facilities. In addition, this gave the City of Brandon the option of expanding this waste water treatment facility as a centralized waste water treatment facility for other future industrial developments in Brandon. Now that the second-shift at Maple Leaf Pork is planned, the City of Brandon is herein proposing to expand the IWWTF.

The existing Maple Leaf Pork processing facility covers an area of about 50,630 m² (545,000 ft²) and was initially proposed to employ about 1,150 people during the first-shift (1999 to present). The plant currently employs about 1,328 people. In addition, there are about 115 salaried employees. The additional employees are required to cover for those absent without leave; those on vacation; and those on maternity leave, etc. The company is now proposing to add a second-shift of approximately 250 to 400 workers (depending on the amount of carcasses shipped to Winnipeg) over as short a period of time as possible (Personal Communication – Gord Maxwell, Vice President, Manufacturing, Brandon). Eventually each shift will process about 54,000 hogs per week with line speeds averaging 1,200 hogs per hour or more. As indicated earlier, Maple Leaf Foods Inc. currently holds Environment Act Licence No. 2311 S2R that includes second-shift operation of the Maple Leaf Pork processing plant.

This proposal is based on and in response to the Manitoba Conservation June 10, 2002, document entitled “Advice Document for the Preparation of an Environment Act Proposal and Environmental Assessment for an Alteration to the City of Brandon’s Industrial Waste Water Treatment Facility”. The environmental goal of the proposed IWWTF is to ensure the plant is designed, constructed, operated; and, ultimately decommissioned in a manner that ensures full compliance with all environmental requirements within the Province of Manitoba, including Water Quality Objectives for the Assiniboine River and the Provincial policies on Land and Water Strategy. Environmental control will be exercised by meeting discharge limits to the Assiniboine River.

1.4 REGULATORY PROCESS

The environmental assessment and licensing of projects in Manitoba is legislated under The Environment Act (the Act) and its subsequent regulations and guidelines. The Act is administered by Manitoba Conservation. Under The Environment Act Classes of Development Regulation (Regulation 164/88), there are three Classes of Developments; Class I, Class II; and, Class III ranging from least disruptive (primarily the discharge of pollutants) to most disruptive (effects of which are of such a magnitude or which generate such a number of environmental issues that it is as an exceptional project). Manitoba Conservation’s “Advice Document for the Preparation of an Environment Act Proposal and Environmental Assessment for an Alteration to the City of Brandon’s Industrial Waste Water Treatment Facility” has defined “the proposed Development” and the term “Proposal” in this instance. The existing City of Brandon’s IWWTF, its proposed alteration to accommodate the second-shift per day operation of the Maple Leaf Pork plant; and, the process waste water pre-treatment facility owned and operated by Maple Leaf Foods Inc., will hereafter be referred to as “the proposed Development”. The term “Proposal” will refer to the City of Brandon IWWTF proposal to be filed concurrently under the Environment Act with the process waste water pretreatment facility alteration to be filed by Maple Leaf Foods Inc.

The City of Brandon’s proposed alteration to their Industrial Waste Water Treatment Facility has been categorized as a Class II development. The process for acquiring a license for the plant is; therefore, governed by Section 11 of the Act; and, a Clean Environment Commission Hearing will be held.

An interdepartmental Technical Advisory Committee (TAC) has been established to provide advice and guidelines for the assessment of potential environmental effects and the preparation of an appropriate Environmental Assessment (EA) report. By agreement between the Province of Manitoba and the Federal Government through “A Canada-Wide Accord on Environmental Harmonization” and its “Sub-agreement on Environmental Assessment”, the TAC consists of provincial department technical staff and federal representation as a matter of protocol in order to facilitate a coordinated approach to the review of proposed projects where both the provincial and the federal jurisdictions have a legislated requirement or interest in the environmental assessment and review of such projects.

1.5 SITE SELECTION PROCESS

The site for the expansion of the IWWTF was pre-planned as part of the original IWWTF and the original pork processing facility layout. As a result, no site selection process was necessary to accommodate this proposed project associated with the second-shift. The proposed expansion will be accommodated adjacent to the existing facility on the current site.

The original site on Section 16 Twp 10 Rge 18WPM on the eastern end of Brandon was selected because:

- It was a location already to be zoned M3, industrial (MH – heavy industrial under new system).
- It was located predominantly downwind of the city.
- It was located nearly 3 km (2 miles) from the nearest built-up area in the City of Brandon.
- It has convenient access to highways both in the east/west direction (Trans Canada Highway) and the north/south direction (P.T.H. #10; and, existing plans to upgrade P.T.H. #110 (Eastern Access) which borders the site.
- It has excellent access to rail (Mainline CP Rail).
- It has excellent access to natural gas (gas line exists on property).
- It has only two householders (one household) within 1 km of the property.
- It offers sufficient space to accommodate the Pork Processing Facility and the accompanying Waste Water Treatment Facility.
- It is conveniently located near the Assiniboine River, which will accommodate the treated effluent from the Waste Water Treatment Facility, while still being away from a designated floodplain.

The need for the proposed Development (expanded IWWTF) stems directly from the introduction of the second-shift at Maple Leaf Pork, while the operational changes to the pretreatment plant would be made over time and in accordance with budgetary constraints.

REFERENCES:

Brandon Economic Development Board (Personal Communication - Mr. Don Allan, formerly General Manager, BEDB)

Manitoba Agriculture, 1997. Agricultural Outlook 98. Cattle and Hogs. Winnipeg.

Manitoba Agriculture & Food, 2001. Agricultural Outlook 2001. Cattle and Hogs. Winnipeg.

Statistics Canada, 1997. Agricultural Profile of Manitoba. Catalogue No. 95-178-XPB. Ottawa.

Statistics Canada, 1992. Agricultural Profile of Manitoba. Catalogue No. 95-363. Ottawa.

Statistics Canada, 1992. Trends and Highlights of Canadian Agriculture and Its People. Catalogue No. 96-303E. Ottawa.