**ECONOMIC INNOVATION & TECHNOLOGY COUNCIL**

Environmental and Analytical Chemistry Services

745 LOGAN AVENUE

WINNIPEG, MANITOBA R3E 3L5

TEL (204) 945-8169 FAX (204) 945-0763

July 30, 1993

Mr Jim Tarrant

Jim's Pump Service

602 Main Street South

Dauphin MB

R7N 1L4

**RE: SOIL SAMPLES - GILBERT PLAINS CO-OP DECOMMISSIONING BULK PLANT**

EITC #	SOIL ID	moisture %	benzene ppm	toluene ppm	ethyl benzene ppm	xylene ppm	total purge-ables $\leq$ C6 ppm	total extract-ables $\geq$ C6 ppm
31299	GP1	27.2	0.14	0.06	0.05	0.13	5.3	<50
31300	GP2	28.9	0.05	<0.05	<0.05	<0.05	<5	<50
31301	GP3	11.5	<0.05	<0.05	0.05	0.06	<5	<50
31302	GP4	25.1	<0.05	<0.05	<0.05	<0.05	<5	<50
31303	GP5	20.1	0.85	5.0	1.3	4.7	230	770
31304	GP6	23.7	<0.05	1.9	<0.05	5.0	78	1300
31305	GP7	21.8	<0.05	0.15	<0.05	1.1	11	90
31306	GP8	11.4	<0.05	<0.05	<0.05	<0.05	<5	<50
31307	GP9	20.4	<0.05	<0.05	<0.05	<0.05	<5	<50
31308	GP10	23.1	<0.05	<0.05	<0.05	0.06	<5	90
31309	GP11	15.4	<0.05	<0.05	<0.05	<0.05	<5	<50
31310	GP12	8.9	<0.05	<0.05	<0.05	<0.05	<5	<50
31311	GP13	16.9	<0.05	<0.05	<0.05	<0.05	<5	<50
31312	GP14	21.2	<0.05	<0.05	<0.05	<0.05	<5	<50

all results reported on "as received" basis

**COMMENTS** Samples received July 12, 1993

Analysis of BTEX and purgeables by Purge &amp; Trap GC/FID (EPA 5030/8015) Analysis of extractables by GC/FID of carbon disulfide extract, against diesel as standard

*Monika Velpel*  
 Monika Velpel  
 Laboratory Supervisor

40 3196

# RAIL YARD TRACKS

Building

Co-OP

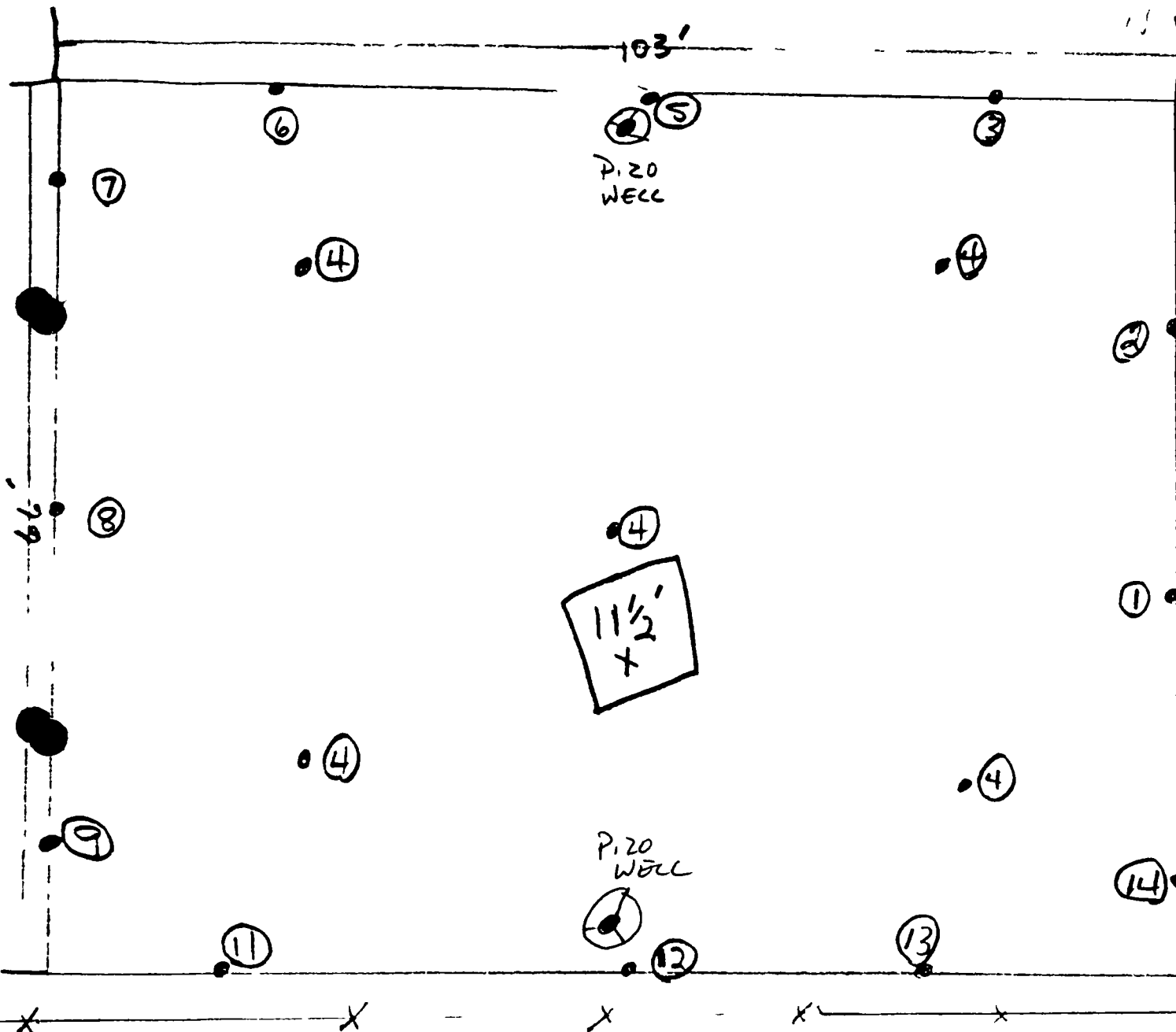

1. 350 PPM (comp)
2. 450 PPM (comp)
3. 100 PPM (comp)
4. 38 PPM (comp)
5. 7800 PPM (comp)
6. 1800 PPM (comp)
7. 70 PPM (comp)
8. 56 PPM (comp)
9. 100 PPM (comp)
10. BTEX H<sub>2</sub>O 950 PPM (HEAD SPACE)
11. 100 PPM (comp)
12. 100 PPM (comp)
13. 120 PPM (comp)
14. 160 PPM (comp)

TOTAL YARDS OUT 2895 yds.  
CLEAR HEAD  
H. H. H.

548-2437



## Memorandum

Date

To

Dave Edger

From

Wayne Kowalsky

Subject

Sublet Plan Coop.

Telephone

Daphn.

feb: 00272

First | Fold

Enclosed info concerning the above.  
I drafted a reply (enclosed) to the Coop  
letter of Oct 1/93.

Would you look it over + if I'm  
off base - let me know - or you  
can sign

Thanks.

Dec 21/03

Drafted a  
standard letter &  
I mailed to Wayne.

JK

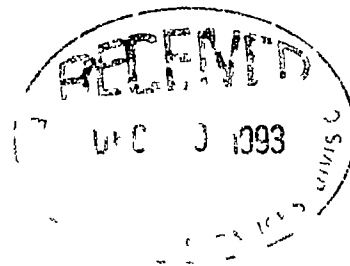



Environment and Workplace  
Safety and Health

Environmental Management  
Inspection

27 — 2nd Avenue, S.W.  
Dauphin, Manitoba, CANADA  
R7N 3E5

December 06, 1993

Gilbert Plains Consumers Cooperations Ltd.  
Box 40  
Gilbert Plains MB R0L 0X0

Re: Bulk Plant DeCommissioning

The soil excavation recommended by Federated Cooperative Ltd. and carried out this past summer by Jim's Pump Service was successful in reducing hydrocarbon concentrations to acceptable levels along the west, south and east perimeter of the excavation. Lab analysis of representative soil samples confirm this result.

Because the location of the railway adjacent to your property prevented soil removal and remediation along the north perimeter, some contamination remained in that area.

The likelihood of the remaining contamination impacting subsurface structures or domestic water supplies (ground water) in the area is thought to be minimal. However, any wells in the vicinity should be identified and their location recorded with our office.

If there is no identified risk to surrounding properties the remaining contaminants may be left on site. The objective will be to manage risk associated with the remaining hydrocarbon levels. This may involve some future monitoring.

The site will continue to be identified as a contaminated property of the Department in order to ensure that the condition is considered in any future development.

For your information.

WV:ch

DRAFT

# Gilbert Plains Consumers Co-operative Ltd.



Box 40 Gilbert Plains Manitoba R0L 0Y0

- HARDWARE
- PETROLEUM
- FEED
- FERTILIZER
- CHEMICALS

PHONES Bulk Dept 548 2078  
Admin Dept 548 2437  
Agro Centre 548 2099

19

October 1, 1993

Department of Environment  
c/o Provincial Building  
27 2nd Ave SW  
Dauphin, Man  
R7N 1S6

Attn Wayne Vanrobaeys

Since the de-commissioning of our old bulk plant has been complete for some time now, would you please send us a letter stating that this has been completed to environmental specifications. Would you please enclose information regarding final test results and release us from further liability in this matter.

This information would be of value to us if and when we wish to sell our property and terminate the lease on the portion of land belonging to Canadian National Railways.

Thank you very much

Sincerely,

A handwritten signature in cursive script, appearing to read "Sandra Yasevichuk".

Sandra Yasevichuk  
office manager

