

Sinclair Unit No. 17
Waterflood Progress Report 2019
January 1st through December 31st 2019

Prepared for:
Manitoba Industry, Economic Development and Mines
Petroleum Branch

Prepared by:
Tundra Oil and Gas
March 17, 2020

INTRODUCTION

Sinclair Unit No. 17 Enhanced Oil Recovery (EOR) Waterflood Project was approved on March 1, 2016 with Tundra Oil and Gas (Tundra) as Operator. The EOR Unit area, outlined in blue, contains 5 abandoned wells, 2 producing vertical wells and 16 producing horizontal wells and 1 horizontal well waiting to be completed, in 48 LSDs in Township 8 Range 28 W1 as shown in the figure below.

This unit is currently not on injection.

Figure 1: Sinclair Unit No. 17 Area Outline

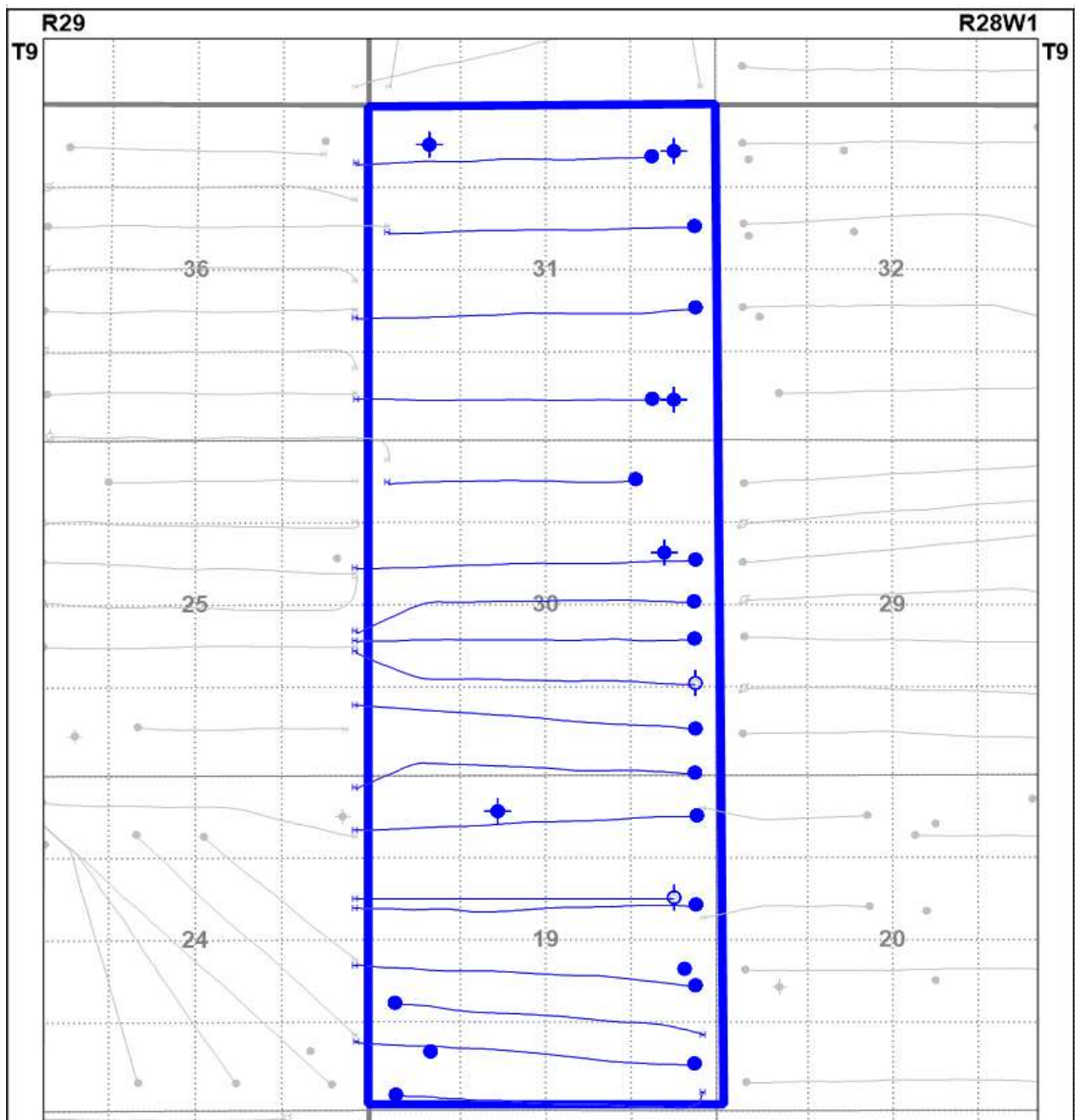



Sinclair Unit No. 17

Tundra Oil and Gas (Tundra), as the operator of the Sinclair Unit No. 17 Enhanced Oil Recovery (EOR) project hereby submits the 2019 EOR report as per section 73 of the Drilling and Production Regulations.

a) Monthly oil and water production rates, injection rate, GOR and WOR

MONTH	Cal Dly Oil m ³ /day	Cal Dly Wtr m ³ /day	Cal Inj Wtr m ³ /day	WOR m ³ /m ³	GOR m ³ /m ³
Jan-2019	32.12	61.10	0.00	1.90	0
Feb-2019	33.11	61.19	0.00	1.85	0
Mar-2019	36.79	49.66	0.00	1.35	0
Apr-2019	31.21	37.26	0.00	1.19	0
May-2019	29.15	33.65	0.00	1.15	0
Jun-2019	25.75	23.78	0.00	0.92	0
Jul-2019	26.90	29.66	0.00	1.10	0
Aug-2019	29.16	28.12	0.00	0.96	0
Sep-2019	28.40	29.57	0.00	1.04	0
Oct-2019	26.89	29.53	0.00	1.10	0
Nov-2019	29.38	43.24	0.00	1.47	0
Dec-2019	26.55	34.55	0.00	1.30	0

b) Cumulative volume of oil, gas and water produced and fluid injected

2019 PRODUCTION	
Produced Oil (m ³)	10,804
Produced Gas (m ³)	0
Produced Water (m ³)	13,983
Fluid Injected (m ³)	0
CUMULATIVE PRODUCTION	
Produced Oil (m ³)	170,505
Produced Water (m ³)	305,817

Sinclair Unit No. 17

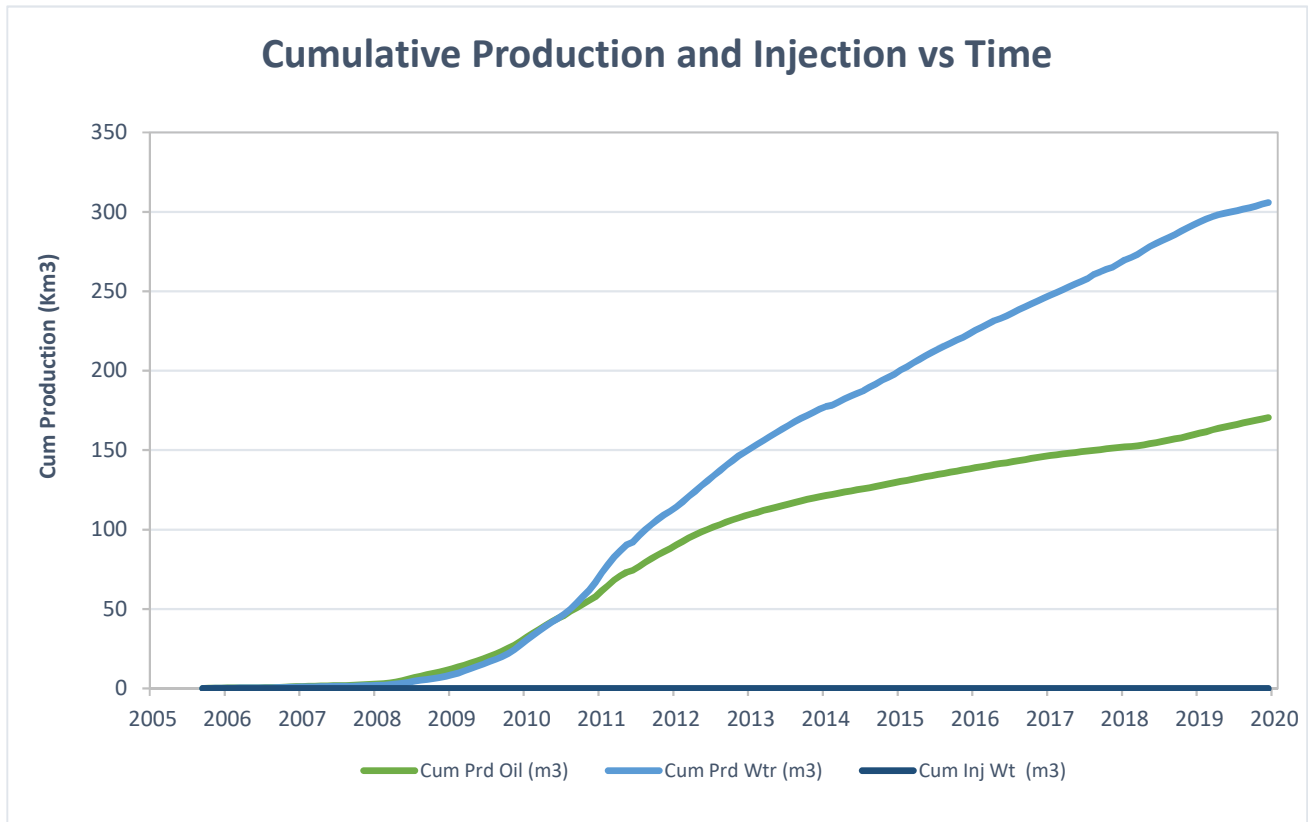

c) Well List

Sinclair Unit No. 17 Well List

<i>UWI</i>	<i>Type</i>	<i>Status</i>	<i>Future Plans</i>
100/01-19-008-28W1/0	Horizontal	Producing	-
100/04-19-008-28W1/0	Vertical	Producing	-
102/04-19-008-28W1/0	Horizontal	Producing	-
100/05-19-008-28W1/0	Horizontal	Producing	-
100/08-19-008-28W1/2	Vertical	Producing	-
102/08-19-008-28W1/0	Horizontal	Producing	-
100/09-19-008-28W1/0	Horizontal	Producing	-
100/14-19-008-28W1/0	Vertical	Abandoned Zone	-
100/16-19-008-28W1/0	Horizontal	Producing	-
103/16-19-008-28W1/0	Horizontal	Producing	-
100/01-30-008-28W1/0	Horizontal	Producing	-
100/08-30-008-28W1/0	Horizontal	Producing	-
103/08-30-008-28W1/0	Horizontal	Drilled & Cased	-
100/09-30-008-28W1/0	Vertical	Abandoned Zone	-
102/09-30-008-28W1/0	Horizontal	Producing	-
104/09-30-008-28W1/0	Horizontal	Producing	-
100/16-30-008-28W1/0	Horizontal	Producing	-
100/01-31-008-28W1/0	Vertical	Abandoned Zone	-
102/01-31-008-28W1/0	Horizontal	Producing	-
100/08-31-008-28W1/0	Horizontal	Producing	-
100/09-31-008-28W1/0	Horizontal	Producing	-
100/13-31-008-28W1/0	Vertical	Abandoned Zone	-
100/16-31-008-28W1/0	Vertical	Abandoned Zone	-
102/16-31-008-28W1/0	Horizontal	Producing	-